

香港大學校外課程手冊

一九七四年春季

SPRING PROSPECTUS

1974



Extra Mural Studies

University of Hong Kong

INFORMATION
REFERENCE
LIBRARY

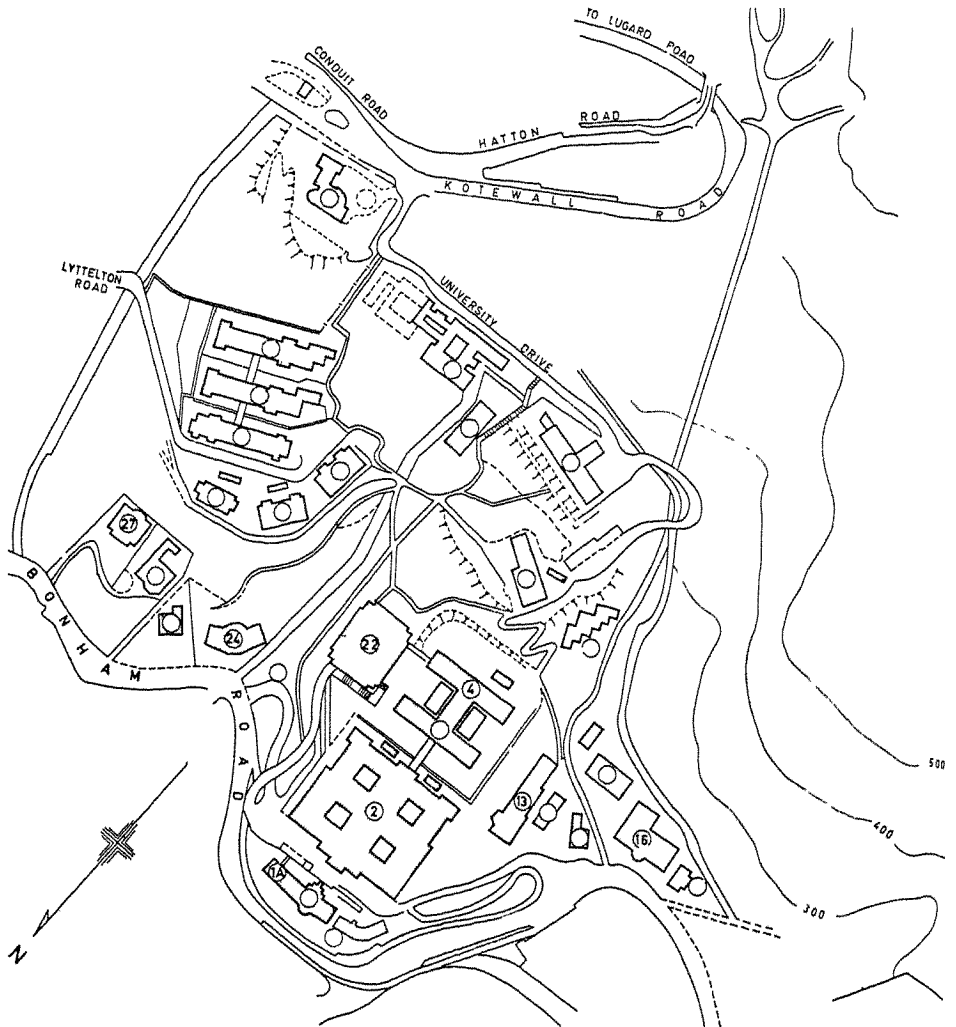

- | | |
|---|---|
| 1a. Bursar's Office | 9. Peel Laboratory |
| 2. Main Building, Loka Yew Hall & Dept. of Extra-mural Studies | 10. Northcote Science Building |
| 4. Library, Faculty of Social Sciences, Centre of Asian Studies & Language Centre | 13. Chemistry |
| 6. Redmond Building | 16. Building 17 (Dept of Electrical Engineering) |
| 8. Duncan Sloss School of Engineering & Architecture | 22. Knowles Building |
| | 24. Fung Ping Shan Museum |
| | 27. Chinese Language School (Tang Chi Ngong Building) |

UNIVERSITY OF HONG KONG GENERAL LAYOUT

Please see inside of rear cover for enlarged plan of Main Building (2) and location of rooms



Extra Mural Studies

University of Hong Kong

DIRECTOR

R. A. Williams, *M.A. (Wales)*

SENIOR STAFF TUTOR

Duncan Macintosh, *M.A. (Cantab.), P.G.C.E. (Lond.), F.R.S.A.*

ASSISTANT TO THE DIRECTOR

Mrs. Priscilla Tso, *B.A., Dip.Ed. (H.K.), Dip.Ad.Ed. (Manc.)*

STAFF TUTORS

T. W. Casey, *B.A. (Nott.), M.B.I.M.*

Miss N. P. Lee, *B.A., Dip.Soc.St. (H.K.)*

Neil Carr, *B.A. (Leic.), M.A. (W.Ontario), Dip.A.D. (Durh.)*

J. P. Bensly, *M.A. (Oxford), M.A. (Reading)*

A. I. Wright, *B.Sc. (Lond.), Ph.D. (Newcastle), G.R.I.C., M.I. Biol.*

D. R. Kemp, *M.Sc., Ph.D., Dip. Microbiol. (London)*

S. G. Redding, *M.A. (Cantab.), Ph.D. (Manc.)*

O. H. H. Wong, *M.A. (H.K.), Ph.D. (Cantab.)*

Mrs. Diane Jones-Parry,

Dip.A.D. (Camberwell), A.T.C. (Hornsey) (Temporary)

ASSISTANT STAFF TUTOR

Wilson W. S. Ng, *M.Sc., Dip. Applied Microbiol. (Strath)*

SECRETARY

Mrs. Yvonne Wong

SPECIAL COURSES

The Department welcomes enquiries and requests from business organizations, government, voluntary bodies or private institutions for specially designed courses to meet their specific education needs.

PRIOR ENROLMENT IS ESSENTIAL

Failure to enrol prior to the opening of a particular course may mean the cancellation of that course. Prior enrolment is the only way the Department of Extra-Mural Studies has of judging the response to its courses. Your co-operation is therefore invited in sending your application forms to the Department as soon as possible.

GENERAL INFORMATION

1. There are normally no entry requirements except that applicants should be over 18 years of age. Occasionally to have the full benefit of a course applicants must possess certain defined qualifications. Applicants are therefore advised to read the description of a course carefully. Professional courses usually have clearly defined entry requirements.
2. The Director may at his discretion refuse to admit an applicant.
3. Unless otherwise arranged, no Extra-Mural lectures will be held:
 - (a) on any public holidays.
 - (b) at a storm warning signal of No. 8 or above. (After the typhoon passes, if the No. 8 signal is lowered before 3 p.m., classes will take place as normal. If the signal is lowered after 3 p.m., classes will be cancelled that evening.)
 - (c) during the following holiday period: January 21-26, 1974 inclusive (Lunar New Year).
4. Fees are not refundable once the course has commenced.
5. Certificates of Attendance are issued, on payment of 50 cents, to those who have attended not less than two-thirds of a course of at least 20 meetings in duration.
6. Closing date for enrolment: one week before the starting date of a course. Late enrolments may not be accepted.
7. For enquiries, please ring either 5-468161 Ext. 307 or 308, or 5-450021 (3 lines), during office hours.

HOW TO ENROL

8. Complete the attached enrolment form and mail it to the Director, Department of Extra-Mural Studies, University of Hong Kong. Forms are also available on request. To ensure that a class can take place, the Department would appreciate early enrolment by applicants.
9. You should send your application form together with the appropriate fee either in the form of a postal order, money order or crossed cheque made out in favour of the UNIVERSITY OF HONG KONG.
10. You will be notified if you are not admitted because of over-subscription or other reasons. **THE DEPARTMENT WILL NOT NOTIFY SUCCESSFUL APPLICANTS WHO ARE EXPECTED TO ATTEND THE FIRST MEETING OF THE CLASS AT THE PLACE AND TIME ADVERTISED.**
11. Applicants can also enrol in person at the following places:
 - (i) Department of Extra-Mural Studies, University of Hong Kong, University Main Building, Ground Floor, Pokfulam Road, Hong Kong (during office hours) (Buses Nos. 3, 3A, 4, 7, 7B, 23, 103). Tel: 5-468161 Ext. 307 or 308.
 - (ii) Extra-Mural Town Centre, Universal House, 11th Floor, 151 Des Voeux Road Central, Hong Kong. Tel: 5-450021 (3 lines) (entrance from Gilman Street). (From 10 a.m. to 6 p.m.)

入 學 須 知

1. 除特別規定學歷之課程外，祇需要年齡超過十八歲者，不限資格，均可申請入學。學員應詳閱課程簡介。
2. 學員被取錄與否，概由校外課程部主任審核報名申請書後決定之。
3. 除特殊情形外，本部在下列期間不授課：
甲：本港公眾假期。
乙：本港天文臺懸掛八號或以上風球之後。（颱風過後，如八號風球在下午三時以前除下，則照常上課，如風球在下午三時以後除下，則當晚課程全部取消。）
丙：農曆新年假期：一九七四年一月廿一日至廿六日。
4. 課程開始後，學費通常不能退還。
5. 凡課程在廿講以上而學員上課次數超過三分之二者，得向本部繳費五角後申請發給聽講證書。
6. 學員應於開課一星期前報名，過期報名可能不被接受。又任何課程額滿後，即隨時截止報名，故學員應儘早報名。
7. 本部詢問電話：5-468161（內線 307 或 308）或 5-450021（3線）。

報 名 手 續

8. 填妥附於本手冊之報名申請書後，逕寄香港大學校外課程部主任收。申請書可隨時向本部索取。
9. 繳費可用支票，銀行本票，或郵政滙票，以「香港大學」名義抬頭，並加橫線，連同申請書逕寄香港大學校外課程部主任收。如用現金則請至本部繳納。
10. 如申請人已獲取錄，本部不再通知，可依時上課。如未獲取錄，則另函通知。
11. 申請人亦可親往下列地點報名：
甲、香港大學校外課程部。
薄扶林道香港大學正座地下（辦公時間內）。
（下列各線巴士均經本部：3, 3A, 4, 7, 7B, 23, 103）。
電話：5-468161（內線 307 或 308）。
乙、校外課程部市區中心。
香港德輔道中一百五十一號環球大廈十二樓（入口在機利文街）。（上午十時至下午六時）。
電話：5-450021（3線）。

CONTENTS

	Page
ART & DESIGN - - - - -	7
Appreciation	
Practical Printmaking; Drawing; and Painting	
ECONOMICS - - - - -	10
EXECUTIVE DEVELOPMENT - - - - -	12
COMMERCE - - - - -	14
EDUCATION - - - - -	17
ENGINEERING - - - - -	19
ENGLISH STUDIES - - - - -	20
GEOGRAPHY - - - - -	22
LAW - - - - -	23
MATHEMATICS - - - - -	25
ORIENTAL LANGUAGES - - - - -	26
Mandarin, Cantonese and Japanese	
ORIENTAL STUDIES - - - - -	29
PSYCHOLOGY - - - - -	31
SCIENCE - - - - -	32
SOCIAL WORK AND SOCIOLOGY - - - - -	34

Art and Design

Staff Tutor : Mrs. Diane Jones-Parry, Telephone 5-450021

APPRECIATION

174. Modern Art Movements Since 1900. Paul Reader, Dip.A.D. (Leeds.). *Tuesdays, 11.00 a.m.-12.30 p.m., starting February 5, 1974. Extra-Mural Town Centre. 15 meetings. Fee \$100*

This course introduces all the significant developments of modern art. It opens with an introduction a little before 1900, and continues through to the present day. The course specifically concentrates on Post-War American painting, and illuminates the development of modern art in its historical context.

Enrolment is limited to 30 persons.

175. Furniture & Interior Design. Gary Salter, B.A. (Oklahoma), B.A. Tulsa (Art History), Dip.Ed. (Georgia). *Tuesdays, 2.30-4.30 p.m., lecture 2.30-4.00 p.m., discussion 4.00-4.30 p.m., starting February 5, 1974. Extra-Mural Town Centre. 10 meetings. Fee: \$100*

After a general survey of the development of the forms of furniture and furnishings from Egyptian times to early modern, this course will concentrate on problems of living today, and in particular, problems of Hong Kong domestic interior design. Discussion of the furniture itself and its deployment, together with problems of scale, use of colours, will be analysed against our own background.

Enrolment is limited to 30 persons.

176. Book Production and Design. Savio Au, *Fridays, 7.00-9.00 p.m., starting February 8, 1974. Extra-Mural Town Centre. 12 meetings. Fee: \$90*

This is a basic course for beginners as well as a supplementary course for those already in the business: publishers, printers, graphic designers and artists; or students in commercial art and design. The course will provide information on every aspect of book design and production; not only with arrangement of type or text, and jacket design, but with editorial work, illustration, estimating, printing machinery and technique, as well as a choice of a printer or compositor.

The course includes trips to printers, publishers and a design studio.

Enrolment is limited to 30 persons.

See also :

Buddhist Art in China (Page 29).

Introduction to the Hindu & Buddhist Art of India (Page 30)

Ecology, Planning & Hong Kong (Page 30)

PRACTICAL PRINTMAKING; DRAWING; AND PAINTING

These are practical classes in the visual arts with emphasis on imaginative painting or drawing, designed to encourage growth of individual creative powers. Work will be carried out in the various media described.

Enrolment is open to students at different stages, beginners being particularly welcome.

Materials will be discussed at the initial meeting in each class and students must provide all materials necessary or buy the same through the department.

In cases where a model is used an additional fee will be charged.

177. Practical Design Course. Paul Reader, Dip.A.D. (Leeds).
*Wednesdays, 2.00-4.00 p.m., starting February 6, 1974. Extra-Mural
Town Centre. 20 meetings. Fee: \$170*

This course introduces fundamental ideas of 2 and 3 dimensional design through practical work. It results in the student producing simple constructions and models for domestic application. Efforts will be made to develop each student's personal approach to design, so that their ideas may be applied to their individual work, and to domestic needs.

Enrolment is limited to 25 persons.

178. 3D Design in Various Media. Miss Martha Lesser, B.S. (N.Y.U.).
*Thursdays, 2.00-4.30 p.m., starting February 7, 1974. Extra-Mural Town
Centre. 15 meetings. Fee: \$150*

Through the use of simple materials—wire, cardboard, styrofoam, papier-mâché, string etc—students will explore the basic principles of 3 dimensional design and its application to everyday life. Students will be expected to provide their own materials.

Enrolment is limited to 20 persons.

179. Portraiture in Various Media. Miss Martha Lesser, B.S. (N.Y.U.).
*Fridays, 10.00 a.m.-12.30 p.m., starting February 8, 1974. Extra-Mural
Town Centre. 15 meetings. Fee: \$150*

Using the human head as "take off point" subject, students explore 2 and 3 dimensional media such as charcoal, pencil, poster paint, papier mâché, wire etc.

Students will be expected to provide their own materials and an additional fee of \$25 will be charged to cover the cost of models.

Enrolment is limited to 17 persons.

180. Printmaking and Experimental Fabric Design. Mrs. Diane Jones-Parry, Dip. A.D. (Camberwell), A.T.C. (Hornsey). *Fridays, 10.00 a.m.-12.30 p.m., starting February 8, 1974. Pokfulam Studio, 144 Pokfulam Road. 12 meetings. Fee: \$120 plus \$25 materials fee*

During the course students will explore the potentials of pattern and print-making; surface printing, wood and lino block and silk screen. They will then experiment with fabric painting and printing, using direct methods as well as printing methods. The emphasis will be on "experimental" as students will be working in the classroom and not laboratory conditions. Beginners welcome. Students will be expected to provide all materials. An additional charge of 25 dollars per head will be made to cover the cost of inks and other sundries.

Enrolment is limited to 15 persons.

**181. 木版水印
(Woodblock Printmaking)**

主 講 人：梁巨廷先生。

講授語言：粵語。

地 點：香港大學校外課程部市區中心。

時 間：一九七四年二月七日起每星期四下午六時至
八時。

學 費：八十元。

此課程共十講，每講二小時，旨在介紹木版水印之版畫技法并引導學員從事版畫創作及各種技法之實驗。

限收二十人。

Economics

Staff Tutor : Neil Carr, Telephone 5-468161 Ext. 301

182. Advanced Commodity Futures Trading. Neil Carr, M.A., and invited specialists. *Mondays and Thursdays, 8.15-9.15 p.m., starting February 4, 1974. Extra-Mural Town Centre. 24 meetings. Fee: \$150*

Economics is a subject studying the scarcity of both natural and human resources and the allocation of these resources among people in their respective capacities as consumers, producers and central authorities and the collective behaviour of these groups at the economic institution called the market.

In the spot market (otherwise known as the cash market), all commodities are normally for immediate delivery. The specific quantity, grade and delivery date for each sales are usually determined by the individual buyer and seller.

A futures market is where commodities which have not been produced are bought and sold. It is an alternate market for both buyers and sellers and provides them with protection against unfavourable price changes which may occur in the spot market. The quantity, grade and delivery date for the commodities are standardized.

A futures market is not a substitute for the spot market. It reduces the risk of spot commitment through the medium of hedging and permits spot trading to increase in a larger volume.

The traditional function of a market is to provide the facilities of exchange for a well-defined commodity.

Speculation is a very risky business, so a commodity speculator should approach futures trading as a business venture and apply sound business judgement and necessary techniques. He must analyse his own financial position to determine how much capital may be allocated for such speculative activity, then to try to select a commodity presenting the safest and yet largest potential profit. A qualified speculator should possess at least a basic knowledge of trading fundamentals and adequate information about the particular commodity.

Consideration will be given to the economic aspects of Commodity Futures trading, from the viewpoint of the development of the Market.

183. 期貨買賣

(An Introduction to Commodity Futures Trading)

主 講 人：楊志剛先生。

講授語言：粵語。

時 間：一九七四年三月十二日起每星期二及星期五
下午八時十五分至九時十五分。

地 點：香港大學校外課程部市區中心。

學 費：一百五十元（共廿四講）。

此課程包括經濟、統計、法律及會計等。旨在基本介紹期貨買賣之理論及實習等。

進一步實習將提供關於在美國、英國及日本等地買賣交易之法例，規定及手續等。

PRIOR ENROLMENT IS ESSENTIAL

Failure to enrol prior to the opening of a particular course may mean the cancellation of that course. Prior enrolment is the only way the Department of Extra-Mural Studies has of judging the response to its courses. Your co-operation is therefore invited in sending your application forms to the Department as soon as possible.

Executive Development

Staff Tutor: T. W. Casey, Telephone 5-468161 Ext. 306

61. 工廠管理問題 (Factory Management Problems)

主 講 人：王文敦碩士。

講授語言：粵語（學員自備參考書）。

地 點：香港大學校外課程部市區中心。

時 間：一九七四年二月十二日起每星期二下午八時十五分至九時四十五分。

學 費：四十五元。

本課程共八講，主要內容包括：工廠管理之理論，如管理之基本原則與管理之組織形式，工廠管理之實務，如生產管理，原材料供應與產品銷售管理，技術管理（包括發展新產品，質量控制及設備維修），人事管理，工作研究，及成本管理等。

本課程適合工廠各級管理人員及其他有興趣人士選讀，能助改善經營，促進業務發展。

r84. Leadership and Motivation. Gordon Redding, M.A., Ph.D.
*Thursdays, 7.30-8.30 p.m., starting February 7, 1974. Knowles Building,
University of Hong Kong. 6 meetings.* **Fee: \$40**

This specialized course is intended for the personnel executive and those concerned with management training and development. It surveys the development of management theory and concentrates on the latest research in the field of motivation. The problems of management control in the human area of business are discussed as well as the problems of applying Anglo-Saxon theory in an Asian context.

185. Management Decision-Making: A Case Study Approach.
Vincent Ng, B.S., M.B.A., M.S. *Tuesdays, 8.15-9.15 p.m., starting February 5, 1974. Extra-Mural Town Centre. 7 meetings.* **Fee: \$40**

The course is designed for practising Managers and students of Management Studies who wish to assess and improve their skills in decision-making by means of the Case Study method. A number of Management Cases have been selected, covering the fields of business expansion, marketing, credit lending, cash forecasting and decisions to make or buy. These cases will form the basis of the course, which in turn will require a high degree of participation from those attending. Formal teaching of the principles of decision-making will be kept to a minimum, as the group of participants will be expected to formulate their own ideas from the case material.

See also :

Introduction to Organizational Behaviour (Page 35).

Commerce

Staff Tutor : Gordon Redding, Telephone 5-468161 Ext. 304

53. Consumer Protection and the Law. Raymond Faulkner, B.A. (Cantab.), Barrister-at-Law, Lecturer in Law, University of Hong Kong. *Mondays, 6.30-8.00 p.m., starting January 28, 1974. University Main Building. 6 meetings.* **Fee: \$30**

The problem for the non-lawyer is not so much the question of solving legal problems because he can go to a professional for that. It is more a question of knowing that his injury, physical or financial, is one for which the law will give redress. This short series of lectures is designed to point out some areas where the law protects the consumer, perhaps without the consumer's knowledge. It will cover contract, sale of goods, hire purchase and the law of negligence. No previous knowledge of the law will be assumed.

58. 銀行實務(二)
(Practical Banking II)

主 講 人：陳天元先生。

講授語言：粵語。

地 點：香港大會堂九樓南演講廳。

時 間：一九七四年二月八日起每星期五下午七時至八時。

學 費：四十五元。

本課程共十二講，繼續講述銀行實務，特別注意進出口押匯及跟單商業信用證。關於香港新銀行條例，中央銀行及其他重要問題，亦加以研討。

186. Principles of Marketing. Gordon Redding, M.A., Ph.D. *Mondays, 4.00-5.00 p.m., starting February 4, 1974. Extra-Mural Town Centre. 6 meetings.* **Fee: \$40**

The course aims to give the businessman a set of concepts with which to think out his marketing problems, and to introduce non-marketing executives to the jargon of the trade. The course begins with a general view of company strategy and the role of marketing and then discusses distribution channels, the product life cycle, diffusion of innovations, the marketing mix, pricing, market segmentation, product differentiation and market research. Constant reference will be made to practical examples.

187. Auditing. Charles M. C. Lo, A.C.C.A., A.I.B.A., *Wednesdays, 5.45-6.45 p.m., starting February 6, 1974. Extra-Mural Town Centre. 20 meetings.* **Fee: \$80**

The latest auditing methods as well as established practice will be discussed in this course, and legislation affecting auditors is covered fully up-to-date.

While the course covers the subject to final examination level of the accountancy bodies, no previous knowledge of auditing is assumed, and it should therefore prove of assistance to both intermediate and final students.

Recommended Reading : Practical Auditing (Spicer & Pegler).
Principles of Auditing (Pitman).

188. Practical Taxation. David Chau, A.C.I.S. *Mondays, 5.45-6.45 p.m., starting February 4, 1974. Extra-Mural Town Centre. 15 meetings.* **Fee: \$50**

The principles and practice of Hong Kong Income Tax Law. Topics include discussion of property tax, salaries tax, profits tax, personal assessment and related problems. Decisions of court cases and the practical aspects of submitting tax returns and appealing against tax assessments will also be discussed.

Recommended Reading : Hong Kong Inland Revenue Ordinance.
Hong Kong Tax Cases.
Hong Kong Taxation—A Taxpayer's Guide.

189. The Structure of Commerce. Liang Chu-chang, B.Sc., M.B.A., Ph.D. *Mondays, 7.30-8.30 p.m., starting February 4, 1974. Knowles Building, University of Hong Kong. 9 meetings.* **Fee: \$45**

Subjects to be discussed in this course include the nature and scope of commercial activity; the main commercial functions, including exchange, transport and storage finance, risk-bearing; supply and demand, and their effect on price under conditions of competition and monopoly; money, bills of exchange, methods of payment and foreign exchange; the balance of payments and International Trade; banks and their main services; business ownership, control, the provision of capital, its use and the relationship of capital, stock, turnover, expenses and profit.

215. 商業機構
(Structure of Commerce)

主 講 人：梁矩章博士。

講授語言：粵語。

地 點：香港大學鈕魯詩樓。

時 間：一九七四年二月四日起每星期一下午六時十五分至七時十五分。

學 費：四十五元。

本課程旨在介紹「商業常識之深刻認識」。

課程內容包括商業之性質及商業活動之範圍；商業之主要任務，包括交易、運輸、倉庫、財務、保障風險；供求對物價在自由競爭及專利等情形下對物價之影響；貨幣、匯票及其他付款方法，如外匯、國際收支平衡與國際貿易；銀行及業務；商業組織及管理；資本之來源；資本之功用及關係；股票週轉、費用及純利（共九講）。

Education

Staff Tutor : Mrs. Priscilla Tso, Telephone 5-468161 Ext. 303

190. A Refresher Course Highlighting Recent Developments in School Counselling, Educational Administration and Modern Classroom Management. N. K. Henderson, Ph.D. (London), B.A., M.Ed. (Melb.), A.B.Ps.S., F.C.P., Professor of Education, University of Hong Kong. *Thursdays, 6.00-7.30 p.m., starting February 7, 1974. Room 121, University Main Building. 12 meetings.* **Fee: \$70**

As this will be the last Extra-Mural course offered in Hong Kong by Professor Henderson, he has agreed to make this refresher course of 12 lectures cover a wide range of topics and bring together for practising teachers the main modern trends in counselling, administration and psychology in the classroom.

Full notes as well as sample tests, data-sheets etc. will be issued at every session. There will be ample time for questions and discussion. Some case-studies in school administration problems typical of Hong Kong and in pupil progress and behaviour difficulties will be analysed.

The course will include topics of interest and value to local teachers in the areas of educational psychology and counselling, school organization and classroom management.

191. 低能(智力)兒童的管教 **(Understanding and Helping the Mentally Handicapped Child—An Appreciation of the Problem)**

主 講 人：由香港低能兒童及青年教育協進會行政秘書鄧福泉先生及本港對低能兒童有研究及直接工作經驗之專業人士擔任。

講授語言：粵語。

地 點：香港大學校外課程部市區中心。

時 間：一九七四年二月四日起每星期一下午六時十五分至七時四十五分。共十四講。

學 費：八十五元。

本課程之目的為使社會人仕、家長、及直接為低能兒童工作之教師、護士、社會工作者、或訓導員，對低能兒童有基本之了解，並在管教方面，有正確之認識。

課程內容包括緒論，社會對低能兒童之照顧，低能兒童之成因及本質（包括醫療方面），低能兒童之需要，及其在家庭、學校、社會及職業方面之適應問題，教育問題，職業訓練等等。

講授方面以粵語為主。方式包括專題講座、電影、討論及參觀低能兒童訓練機構等。限收三十名。在職專業者及兒童家長將獲優先取錄。

（本課程由香港低能兒童及青年教育協進會贊助）

192. 低能兒童(中度)教學研究

Practical Techniques with the Mentally Handicapped (Moderate Grade)

主 講 人：鄧福泉先生；
黃佩霞女士。

講授語言：粵語。

地 點：香港大學校外課程部市區中心。

時 間：一九七四年四月十六日起每星期二及星期五
下午六時十五分至七時四十五分。

學 費：一百元。

本課程共十六講，內容包括低能兒童身心方面的發展；學習上的各種因素；設計教學法；程序教學法；準確教學法；語言教學法及數學教學法；行爲矯正法；課程設計，時間表編排，觀察及報告編寫，教具製作等；活動設計及與家長方面的合作等等。

申請者如曾參加本部「低能(智力)兒童的管教」課程並為現任低能兒童(中度)訓練中心工作人員將獲優先取錄。限收20人。

（本課程由香港低能兒童教育協進會贊助）

Engineering

Staff Tutor : Mrs. Priscilla Tso, Telephone 5-468161 Ext. 303

193. Introduction to Petroleum Technology. P. I. F. Niem, B.Sc. Tech., Ph.D. (Manc.), A.M.C.T., C.Eng. M.I.Chem.E., F.Inst. Pet., Lecturer in Industrial Engineering, H.K.U.; P. F. Y. Wong, B.Sc., Ph.D. (Birm.), C.Eng., M.I.Chem.E., A.M.Inst.F., Lecturer in Mechanical Engineering, H.K.U. *Tuesdays, 6.15-8.30 p.m., starting February 5, 1974. Knowles Building, University of Hong Kong. 10 meetings.* **Fee: \$100**

This course is designed for school teachers and engineers in industry and commerce. It aims to provide up-to-date knowledge of the science and technology of petroleum and its derivatives.

The following topics will be covered: origin of oil and its classification; physical chemistry of hydro-carbons; manufacturing processes and the oil refinery; standard methods for testing of petroleum products; linear programming of product blending and market simulation; petroleum chemicals including plastics.

UNIVERSITY ENTRANCE

The attention of extra-mural students is drawn to the following regulation of the University of Hong Kong regarding admission to the University:

'A mature person without formal academic qualifications who is aged 30 or over on September 1 of the year in which admission is sought may be exempted completely from University entrance requirements but shall not be eligible for admission to the Faculty of Medicine.'

Enquiries about this exemption clause should be addressed to the Registrar, University of Hong Kong.

English Studies

Staff Tutor : Duncan Macintosh, Telephone 5-456443

194. Reading and Discussion. H. F. Price, B.A. (Simon Fraser).
*Fridays, 6.15-7.45 p.m., starting February 1, 1974. Wah Yan College,
Queen's Road East. 10 meetings.* **Fee: \$50**

This further course, which is intended for those who have a good command of English and which is particularly suitable for teachers and journalists, is aimed at providing ample opportunity to consider different kinds and styles of writing in English. In addition to the textbook mentioned below, a number of examples of different kinds of non-literary prose will be made available during the course for critical examination and discussion in class. The tutor will lead the discussions and explain how the writers achieved a certain effect by the way in which they wrote. *Minimum qualification for enrolment : a Pass in English at G.C.E. "Ordinary" level or equivalent. Enrolment will be limited to 25 persons and may be by selection.* Suitably qualified applicants are advised to apply for enrolment in Course 195, "Style in Writing", as well.

Textbook: W. E. K. Anderson: *The Written Word* (O.U.P.) which may be obtained from the Hong Kong Book Centre, Des Voeux Road Central.

195. Style in Writing. Michael Smithies, M.A. (Oxon.), M.A. (Calif.),
L-ès-L (Paris), F.R.A.S., University of Hong Kong. *Tuesdays and
Thursdays, 6.15-7.45 p.m., starting April, 16, 1974. University Main
Building. 10 meetings.* **Fee: \$50**

An intensive course in writing aimed at distinguishing and practising different styles in English. The tutor will provide those attending the course with guidance as to how they can express themselves in different situations, and numerous exercises will be set. *All those applying for enrolment should have obtained a Pass in English at Hong Kong University Matriculation level or equivalent. Enrolment will be limited to 20 persons and may be by selection.* Applicants may also wish to apply for enrolment in Course 194, "Reading and Discussion".

196. The Plays of The Hong Kong Arts Festival. Miss V. Ooi, B.A. (H.K.), Ph.D. (Bristol), Lecturer in English, University of Hong Kong. *Wednesdays, 6.30–8.00 p.m., starting February 13, 1974. Knowles Building, University of Hong Kong. 5 meetings.* **Fee: \$25**

This short course of discussion seminars is intended specifically for those who have been to see the plays performed during the Hong Kong Arts Festival, 1974. The tutor will lead discussions on the actual performances of the plays in question and will answer questions on them.

The plays to be considered are as follows:

- 13th February: W. Shakespeare — Twelfth Night;
- 20th February: P. Schaffer — The Royal Hunt of the Sun;
- 27th February: H. Middleton — The Changeling;
- 6th March: W. Shakespeare — Henry V;
- 13th March: E. Bond — The Pope's Wedding.

Geography

Staff Tutor : O. H. H. Wong, Telephone 5-468161 Ext. 309

197. Geographical Analysis. Chung Yuet Ping, B.A. (C.U.H.K.), M.A. (Kent), Ph.D. (Minn.). *Mondays, 6.15-7.45 p.m., starting February 4, 1974. Knowles Building, University of Hong Kong. 8 meetings. Fee: \$40*

This course is a study of geographic thought and research methods on geographic problems. About one-fourth of the course will cover discussions on some of the basic spatial concepts which are essential for the explanation or synthesis of theories in geography. The rest of the course introduces some of the basic quantitative approaches which have been employed by human geographers to solve problems. Included in the few case studies which illustrate the scope of research procedures in geography, is a lecture on mental maps of Hong Kong households and their construction.

100. Geography in the Field. Victor F. S. Sit, B.A. (H.K.). *Thursdays 6.30-8.00 p.m., starting February 7, 1974. Room 142, University Main Building. 8 meetings plus 3 field trips. Fee: \$70*

A general course outlining certain interesting aspects of both the physical and human geography of Hong Kong. The emphasis is on the interplay of physical and human factors on urban renewal schemes, the squatter problem, industrial townships and the changing pattern of rural land uses.

Priority will be given to post-secondary students and teachers. Those who have attended the same course in the fall of 1973 need not apply.

Enrolment is limited to 35 persons.

See also :

Ecology, Planning & Hong Kong (Page 30).

Law

Staff Tutor : Mrs. Priscilla Tso, *Telephone* 5-468161 *Ext.* 303

198. Company Law and Partnership. R. F. H. Wong, LL.B., B.C.L., Barrister-at-Law of the Lincoln's Inn. *Mondays, 6.15-8.30 p.m., starting February 4, 1974. Knowles Building, University of Hong Kong. 15 meetings.*
Fee: \$110

The course will be divided into the following two parts:

Part One : Company Law—formation, memorandum and articles and alterations thereto, contracts and dealings with companies, share capital, allotment and transfer of shares, dividends, debentures, directors and shareholders' meetings, private companies, winding up.

Part Two : Partnership—definition, formation, relations between parties, relations to third parties, liability of parties, dissolution.

199. 市民與法律 (Law and the Citizen)

主 講 人：韓譚春先生。

講授語言：粵語。

地 點：香港大學校外課程部市區中心。

時 間：一九七四年二月八日起每星期五下午五時四十五分至七時十五分。

學 費：五十五元。

本課程共十五講，每週一次，旨在引起市民對法律之興趣與認識。主要內容包括：

(一) 本港法庭的司法程序，律師和法庭的種類。

(二) 政府的法律援助。

(三) 刑事法和民事法的分別，民事不法行爲的訴訟，誹謗和疏忽等。

(四) 道路交通法例。

(五) 勞工和僱傭法例。

(六) 合約的種類，成立和實行。

200. 住客與業主 (Landlord and Tenant)

主 講 人：韓譚春先生。

講授語言：粵語。

地 點：香港大學校外課程部市區中心。

時 間：一九七四年一月卅一日起每星期四下午五時三十分至七時。

學 費：三十元。

本課程共八講，目的在使市民認識香港現行法律對業主和住客的保障，着重說明土地支配權及樓宇的買賣手續。

201. 銀行法 (Banking Law)

主 講 人：郭慶偉先生。

講授語言：粵語（輔以英語）。

地 點：香港大學鈕魯詩樓。

時 間：一九七四年二月七日起每星期四下午六時卅分至八時。

學 費：七十元。

本課程共十五講。旨在以簡易之方法，使市民與銀行僱員對香港銀行法例作基本認識。內容包括銀行與顧客之關係；商業貸款；扣押債務人在第三者手中之債權；儲蓄存款；支票及其他票據；銀行之責任和法律對銀行之保障；墊款之保證；抵押及其他債務擔保；商業信用等。

202. 社區工作與法律（一）

(Some Aspects of the Law and Community Work I)

主 講 人：韓譚春先生。

講授語言：粵語。

地 點：香港大學校外課程部市區中心。

時 間：一九七四年四月四日起每星期四下午五時卅分至七時。

學 費：五十元。

本課程共十講，目的在使與社區工作有關的人士，了解社區工作中涉及到的各項與法律有關的問題。主要內容包括：香港司法機構和法律程序；市民的權利和義務；公安法和刑事法，包括重要罪案如暴動，非法集會等等。

Mathematics

Staff Tutor : Mrs. Priscilla Tso, Telephone 5-468161 Ext. 303

203. Advanced Level Applied Mathematics. C. L. Chan, B.Sc. (H.K.), Ph.D. (Br.Col.), Lecturer in Mathematics, H.K.U.; K. Y. Chan, B.Sc. (H.K.), Ph.D. (Birm.), Senior Lecturer in Mathematics, H.K.U.; C. K. Leung, B.Sc. (C.U.H.K.), M.Sc. (Lond.), M.I.S., Lecturer in Statistics, H.K.U. *Wednesdays, 6.00-7.30 p.m., starting February 6, 1974. Knowles Building, University of Hong Kong. 10 meetings. Fee: \$80*

The course is intended primarily for teachers of Advanced Level Mathematics. It consists of a series of lectures on the Fundamentals of Statistics and Mechanics, followed by discussion sessions. Topics of discussion will include: the meaning of Applied Mathematics, the interplay of Mathematical Methods and Theoretical Mechanics in Advanced Level Applied Mathematics and the problems encountered in teaching Applied Mathematics.

Fee Refund: *Teachers of Mathematics at Advanced Level who wish to have their fees refunded by the Director of Education are required to complete an application form (obtainable from the Department of Extra-Mural Studies, University of Hong Kong) which must be returned directly to the Director of Education before the commencement of the course. This applies to all teachers whether in Government, aided or private schools.*

204. 小學數學活動

(Activities and Games in Primary Mathematics)

主 講 人：馮源先生。

講授語言：粵語。

地 點：香港大學校外課程部市區中心。

時 間：一九七四年二月十二日起每星期二下午六時
十五分至七時四十五分。

學 費：五十五元。

本課程共十講，專為小學校長及教師而設，旨在提供較新之數學教學法，以多種活動及遊戲之方式，使兒童對數學發生興趣及增加理解。內容包括「十進制單位之認識」，「圖像及關係之研究」，「有趣的幾何圖形」等等。

Oriental Languages

Staff Tutor : O. H. H. Wong, Telephone : 5-468161 Ext. 309

The Oriental Language programme is taught in English, Mandarin and Cantonese as described. A good standard in the appropriate medium is essential to gain full benefit from the course.

Laboratory assistance for Mandarin I/II, Cantonese I/II, and Kuo Yu is available at Caritas House, Caine Road, at \$25 per 12 hours of study. Students of these courses, however, will be given one hour of conducted laboratory exercise during course time to familiarize themselves with the system.

MANDARIN

205. Mandarin I. Tyrone S. C. Wang, B.A. (Yen-Chiang), Language Tutor, University of Hong Kong. *Tuesdays and Fridays, 6.15-7.15 p.m., starting February 5, 1974. Knowles Building, University of Hong Kong. 50 meetings.* **Fee: \$250**

The main emphasis of this course will be on spoken Mandarin and ample opportunity will be given for practising pronunciation and short sentence construction orally.

Textbook: *Beginning Chinese* by John De Francis.

135. 初級國語 (Kuo Yu)

主 講 人：白選之學士。

講授語言：粵語。

地 點：香港大學校外課程部市區中心。

時 間：一九七四年二月十二日起每星期二及星期五
下午八時至九時三十分。

學 費：一百五十元。

本課程共三十講（包括錄音室練習一小時半），每週二講，每講一小時半。內容有國語注音符號（包括注音字母及大陸現行標準拼音法），國、粵語發音，語法和詞句的差異，國語會話和文章選讀等。

CANTONESE

Cantonese I

The main emphasis of this course will be on basic grammar in spoken Cantonese and ample opportunity will be given for practising pronunciation and short sentence construction orally.

Textbook: *Speak Cantonese, Book I* by Parker Po-fei Huang and Gerard P. Kok, Yale University Press.

206. Cantonese I. Francis Sham, B.A. (Sun Yat-sen). *Mondays and Thursdays, 2.00-3.00 p.m., starting February 4, 1974. Extra-Mural Town Centre. 50 meetings.* **Fee: \$250**

207. Cantonese I. C. S. Hung, B.A. (Chinan), Language Tutor, University of Hong Kong. *Tuesdays and Fridays, 6.15-7.15 p.m., starting February 5, 1974. Knowles Building, University of Hong Kong. 50 meetings.* **Fee: \$250**

Cantonese II

This course, intended for students who have completed Cantonese I or who can prove that they have had equivalent training in Cantonese, will concentrate on oral expressions and idioms.

Textbook: *Speak Cantonese, Book I* by Parker Po-fei Huang and Gerard P. Kok, Yale University Press.

208. Cantonese II. Francis Sham, B.A. (Sun Yat-sen). *Tuesdays and Fridays, 2.00-3.00 p.m., starting May 3, 1974. Extra-Mural Town Centre. 30 meetings.* **Fee: \$180**

209. Cantonese II. C. S. Hung, B.A. (Chinan), Language Tutor, University of Hong Kong. *Mondays and Thursdays, 6.15-7.15 p.m., starting May 6, 1974. Knowles Building, University of Hong Kong. 30 meetings.* **Fee: \$180**

JAPANESE

210. 初級日語 (Japanese I)

主 講 人：陳志誠碩士。

講授語言：粵語。

地 點：香港大學校本部。

時 間：一九七四年二月五日起每星期二及星期五下午
六時十五分至七時十五分。共六十講。

學 費：一百五十元。

初級日語課程，以學習現代日語基礎為目的。內容包括日語發音和「假名」基本文法，常用語句及商業會話等。

課本：よんかた（日本國際學友會日本語學校編）。
NHK日語講座教材（由主講人供應）。

Oriental Studies

Staff Tutor : O. H. H. Wong, *Telephone* 5-468161 *Ext.* 309

211. The Ancient Civilisation of China. O. H. H. Wong, M.A. (H.K.), Ph.D. (Cantab.). *Mondays, 7.00-8.30 p.m., starting February 4, 1974. Knowles Building, University of Hong Kong. 14 meetings. Fee: \$50*

To understand Modern China, it is essential to have some knowledge of Ancient China, which, in itself, is a fascinating study. To this end, the following topics have been selected for discussion: the cradle of Chinese civilisation; geographic influences on Chinese history and culture; trends in Chinese history, particularly the dynastic cycle; ways of Chinese thinking; the Chinese mode of life and social structure; political concepts; the Chinese as an artistic nation; early Chinese contacts with the outside world.

Little or no previous knowledge of Chinese History will be assumed.

Staff Tutor : Mrs. Priscilla Tso, *Telephone* 5-468161 *Ext.* 303

212. Buddhist Art in China. Chuang Shen, B.A. (Taiwan), M.A. (Prin.), Lecturer in Chinese, University of Hong Kong. *Thursdays, 6.00-7.30 p.m., starting February 7, 1974. Extra-Mural Town Centre. 15 meetings. Fee: \$65*

This illustrated course will provide an introduction to the Buddhist art of China. The course will deal with the following three aspects: Buddhist architecture, sculpture and painting. The newly discovered archaeological material of Chinese monumental works will be used to illustrate the artistic transmission of Buddhist art from India via Central Asia and finally to China.

The course will commence with a study of rock-cut caves in China followed by a survey of Buddhist temples and pagodas. It will also deal with the mythology and iconography of Buddhism; Buddhist sculptures; Buddhist wall paintings and their influence on Chinese secular art. The course will conclude with a survey of the influence of Zen Buddhism on Chinese painting and the spread of Zen Buddhism to Japan.

213. An Introduction to the Hindu and Buddhist Art of India. Mrs. Rajeshwari Ghose, B.A. Hons. (Calcutta), M.A. (H.K.). *Fridays, 2.30-4.00 p.m., starting February 8, 1974. Extra-Mural Town Centre. 18 meetings.* **Fee: \$80**

This illustrated course will provide an introduction to the Hindu & Buddhist art of India. It will commence with a survey of the development of both religions and discuss their beliefs, mythology and iconography. It will examine at length the development of secular and religious architecture in India—the Hindu rock-cut temples, the Buddhist cave monasteries, the Hindu temple in south India and its development as a temple-town. It will also deal with the different Schools of Indian Sculpture—the classical and romantic trends, the erotic sculptures of north and east India, bronze casting, terracottas, ivory carving and the fascinating murals and fresco paintings of Ajanta.

The course will conclude with a very brief glimpse of the spread of these art forms and concepts in Nepal, Tibet and Southeast Asia.

224. Ecology, Planning & Hong Kong. Jon A. Prescott, B. Arch., M.C.D., H.K.I.A., R.I.B.A., M.R.T.P.I., Brian Hadland, Dip. Arch., Dip. T.P., R.I.B.A., M.R.T.P.I., Barry Will, B. Arch., M. Urb. Studies (Queensland). *Mondays, 6.15-8.00 p.m., starting February 4, 1974. Knowles Building, University of Hong Kong. 10 meetings.* **Fee: \$100**

This is the second of a series of seminars and lectures on the problems of planning in Hong Kong, at which a series of guest speakers will deal with particular topics.

All are welcome, as it is hoped that the problems and conditions of our environment, and their effects on the inhabitants of Hong Kong—and elsewhere—are problems which are of vital importance to everyone.

Enrolment is limited to 30 persons.

Psychology

Staff Tutor : Miss N. P. Lee, Telephone 5-468161 Ext. 308

214. Decision-making and Choice. Joseph A. Precker, Ph.D. (Columbia). Tuesdays, 6.15-7.45 p.m., starting February 26, 1974. Knowles Building, University of Hong Kong. 6 meetings. **Fee: \$30**

Important decisions, major choices, may lead to apprehensiveness and indecisiveness. Indeed, for some people *all* significant choices and decisions may be preceded by unrest, concern, and anxiety.

How to make *effective* decisions, efficiently and productively, will be considered in this short course of six sessions. First, however, the psychological and social factors contributing to choice and decisions will be examined, attempting to co-ordinate the findings of such diverse investigators as the psychoanalysts at one extreme, and the organization theorists at the other.

Lectures and discussions will be geared to the special interest of the class, and include problems of choice and decision making in personal life, family life, and at work.

157. 心理學基本原理(二) (Basic Principles in Psychology II)

主 講 人：梅錦榮先生。

講授語言：粵語。

地 點：香港大學校外課程部市區中心。

時 間：一九七四年二月十三日起每星期三下午七時
四十五分至九時十五分。共十二講。

學 費：六十元。

這是心理學基本原理(一)的延續，目的是叫學員能夠對這課題內的其他方面有充分的了解，以達到對心理學基本原理有全面性的認識，內容將包括下列分題：

- 一、動機——動機的性質，生理與心理的動機；動機的測量法；研究動機應考慮的要點，與及動機理論等。
- 二、情緒——包括其性質與理論；情緒的發展及其對生理的變化與心理健康的關係。
- 三、感覺與知覺——感覺的基本特徵；個人對時間、方向、及運動的知覺；知覺恒常性；錯覺與幻覺，影响知覺的因素等。
- 四、智力——智力的定義；智商；智力測驗；心理測驗的效度和信度；智力的成長與衰退；遺傳與環境的因素等。

會修讀心理學基本原理(一)的學員，將被優先考慮參加這課程。

Science

Staff Tutor : D. R. Kemp, Telephone 5-468161 Ext. 551

ECOLOGY FOR LOWER SECONDARY SCHOOL TEACHERS

The following courses are primarily designed for teachers in lower secondary schools but should also be of interest to fifth & sixth form teachers. It is possible to attend only one course but it is highly desirable to attend both to obtain a full coverage of the subject.

216. Plant Ecology. *Tuesdays, 6.15-8.15 p.m., starting January 29, 1974. Knowles Building, Room 722, University of Hong Kong. 10 meetings, followed by a field weekend at the Wu Kwai Sha Youth Village on April 6th and 7th.* **Fee: \$110**

Tutors : D. R. Kemp, M.Sc., Ph.D. (London), M.I.Biol., Staff Tutor in Science, Department of Extra-Mural Studies, University of Hong Kong.
I. J. Hodgkiss, Ph.D. (Wales), F.L.S., Lecturer in Botany, University of Hong Kong.
Mrs. S. L. Thrower, Ph.D. (Melb.), L.O.Sc., Honorary Research Fellow in Botany, University of Hong Kong.

The course will deal with methods of recording and identifying plants. Slides will be used to illustrate local species. The common plant communities found in Hong Kong will be dealt with (aquatic habitats, mangrove swamps, woodlands and grassland) and special adaptations to the environment considered, e.g. insectivorous plants. Students will be encouraged to take part in discussions concerning ecological projects in schools.

217. Animal Ecology. *Tuesdays, 6.15-8.15 p.m., starting April 9, 1974. Knowles Building, Room 722, University of Hong Kong. 10 meetings, followed by a field weekend at the Wu Kwai Sha Youth Village on June 15th and 16th.* **Fee: \$110**

Tutors : D. R. Kemp, M.Sc., Ph.D., M.I.Biol.
John Romer, M.B.E., M.I.Biol., M.R.S.H., M.C.Z.S.
M. A. Webster, M.A.
Roger Duggan, M.Sc.
Stephen Hui, B.Sc.
L. F. Fung, B.Sc.
Patsy Wong, B.Sc.

The course will deal with methods of sampling animals in their natural habitats, animal classification and the study of animal communities in marine and terrestrial surroundings. Some unusual and interesting animal life histories will be considered and some attention paid to amphibia, reptilia and birds with emphasis on local species. Finally the tenuous existence of rare and vanishing species and the possible existence of such zoological question marks as the yeti and the Loch Ness monster will be discussed.

Fee Refund: *Teachers of Biology who wish to attend the above courses on Plant & Animal Ecology may apply for a fee refund from the Director of Education. Applicants are required to complete an application form (obtainable from the Department of Extra-Mural Studies, University of Hong Kong) which must be returned directly to the Director of Education before the commencement of the course. This applies to all teachers whether in Government, aided or private schools.*

PRIOR ENROLMENT IS ESSENTIAL

Failure to enrol prior to the opening of a particular course may mean the cancellation of that course. Prior enrolment is the only way the Department of Extra-Mural Studies has of judging the response to its courses. Your co-operation is therefore invited in sending your application forms to the Department as soon as possible.

Social Work and Sociology

Staff Tutor : Miss N. P. Lee, *Telephone* 5-468161 *Ext.* 308

219. Use of Social Work Theories. Y. T. Hui, M.S.W. (Virginia Commonwealth University). *Mondays, 7.30-9.00 p.m., starting February 18, 1974. Extra-Mural Town Centre. 12 meetings.* **Fee: \$60**

“Despite the fact that casework was defined . . . forty eight years ago and that much has subsequently been written on differential assessment and treatment methods, there is still a good deal of confusion about the nature of casework and the range of caseworkers’ activities.”

Margaret A. G. Brown.

This course is an attempt to delineate the concepts and use of the major casework approaches, which includes crisis intervention; diagnostic theory; functional theory; problem-solving theory; behaviour modification theory; psychosocial theory; reality therapy and so forth.

It is specially designed for the benefit of those who have already had some basic understanding and training in social casework. Classes will be conducted in the form of lecture, discussion and case study.

221. 社會工作督導 (Supervision in Social Work)

主 講 人：羅韶光女士。

講授語言：粵語（輔以英語）。

地 點：九龍窩打老道五十四號楊震服務中心三樓會議室。

時 間：一九七四年二月八日起每星期五下午六時至七時三十分。共八講。

學 費：四十五元。

社會工作督導在提高工作的質素，加強工作人員對工作的興趣，盡量發揮各種社會工作的方法，將理論付諸實踐，及培養新血等方面，都佔了相當重要的地位。

這課程是特別為在福利機構負責督導社會工作人員及學生之人士而設，主要內容包括督導的定義，原則和範圍；如何了解不同的學習方式；技巧的運用，釐定檢討的基本依據等。

授課方式將利用研討，個案分析，和角色扮演等，以加強學員對社會工作督導的了解和實踐，歡迎各學員從工作經驗中提出例子，共同研究。

222. 社會學入門
(Introduction to Sociology)

主 講 人：葉富強先生。

講授語言：粵語。

地 點：香港大學校外課程部市區中心。

時 間：一九七四年三月廿六日起每星期二下午六時
至七時卅分。共十講。

學 費：五十元。

本課程希望用簡單淺易的方法，闡釋社會學的基本概念，原理及研究方法。課程除包括社會學對文化、性格、社會組織、社會結構、社會互動、人類生態學，及社會變遷等方面的研究外，還特別注重認識社會現象的社會學實驗，務求學員能夠獨立地進行簡單的實驗，從日常生活中更了解我們的社會。

223. **Introduction to Organisational Behaviour.** Mick J. Bennett. B.A. (Keele), M.Phil. (Lond.), David A. Levin. B.A. (Econ.) Wisc., M.A. (Ill.). *Mondays, 6.30-8.00 p.m., starting February 18, 1974. Knowles Building, University of Hong Kong. 10 meetings.* **Fee: \$50**

This course will look at some sociological and psychological aspects of work organisations with particular reference to Hong Kong. Topics will cover a variety of subjects such as the social organisation of work in small and large firms, occupational interest groups, managerial styles, organisational change etc.

PRIOR ENROLMENT IS ESSENTIAL

Failure to enrol prior to the opening of a particular course may mean the cancellation of that course. Prior enrolment is the only way the Department of Extra-Mural Studies has of judging the response to its courses. Your cooperation is therefore invited in sending your application forms to the Department as soon as possible.

預早報名之重要

及早報名乃是使本部得知各界對種種課程反應之唯一途徑，如不及早報名則往往引致各該課程延期或取消。故有志修讀本部課程者，敬希從速將報名申請書寄回本部。

University of Hong Kong Department of Extra-Mural Studies

香港大學校外課程部

The whole of this form together with the appropriate fee should be sent to
THE DIRECTOR OF EXTRA MURAL STUDIES
THE UNIVERSITY OF HONG KONG.

申請書連同後附學費送交香港大學校外課程部主任

Payment may be made in cash or by cheque at the University or by post. Cheques should be crossed and made payable to "University of Hong Kong".

繳費可用支票或現金，如用支票請以「香港大學」名義抬頭，並加橫線，逕寄本部。

The issue of an Enrolment Application Acknowledgment does not of itself constitute acceptance of the application, but if you do not hear otherwise before a course starts, you may assume you have been accepted. If for any reason you are not accepted your fee will be returned, but otherwise fees are not normally refundable.

除非課程臨時取消或改期，請依照公佈日期上課，本部不另通知。如報名申請未被接受，學費將退還；但課程開始後，學費通常不能退還。



UNIVERSITY OF HONG KONG 香港大學
EXTRA MURAL STUDIES 校外課程

APPLICATION FOR ENROLMENT 報名申請書
Please use a separate form for each course 每一申請書祇適用於一種課程

Course No. 課程號碼 _____ Course name 課程名稱 _____
Fee enclosed 附學費 \$ _____ Cash/Cheque No. 現金/支票號碼 _____

Name in full 姓名 (Mr./Mrs./Miss) English 英文 _____
(in block letters—surname first) Chinese 中文 _____

What Extra Mural Courses have you previously attended? 曾修讀之其他校外課程

Name in full 姓名 (Mr./Mrs./Miss) English 英文 _____
(in block letters—surname first) Chinese 中文 _____

Correspondence address 通訊處

Office address 辦事處地址

Telephone Nos. 電話 Home 住宅 _____ Office 辦事處 _____

Nationality 國籍 _____ Age (please tick age group): 18-19 40-49
Occupation 職業 _____ 20-29 50-59
30-39 over 60

Education (please tick) 教育程度 (請加 V 於適當方格內)
 Primary 小學 College of Education 師範
 Secondary 中學 University 大學
 Technical College 工專 Post graduate 研究院
Others 其他 _____

Degree or professional qualification held 大學學位或專業資格 _____
Date 日期 _____ Signature 簽字 _____

For Office Use 不必填寫 →

Date 日期	Reg. No. 註冊號碼	Course No. 課程號碼	Amount 金額

For Office Use 不必填寫 →

Date 日期	Reg. No. 註冊號碼	Course No. 課程號碼	Amount 金額

Please also complete this part.

Note: This application acknowledgment is not complete without validation by official printing machine entry of the details at X above at the University or Town Centre office of the Department of Extra-Mural Studies, University of Hong Kong.

請填妥本欄。
注意：本收條未經本部或本部市區中心辦事處收銀機在 X 欄內印出金額、日期等，即未生效。

Name 姓名	_____
Full Postal Address 地址	_____

Fees are not refundable once the course has commenced 課程開始後學費不能退還。 Please see overleaf 請看背面。

GROUND PLAN OF UNIVERSITY OF HONG KONG MAIN BUILDING

showing location of rooms used for extra mural courses Please see inside of front cover for University general layout.

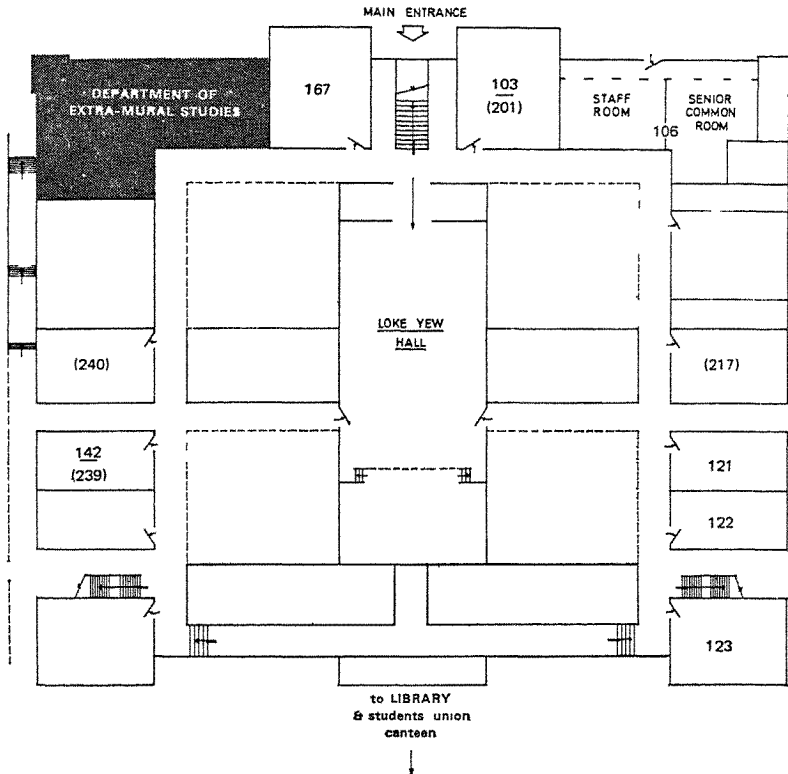

LIBRA PRESS LTD.

56 Wong Chuk Hang Road, Hong Kong

香港大學校外課程手冊

一九七四年春季

SPRING PROSPECTUS

1974



Extra Mural Studies

University of Hong Kong

INFORMATION
REFERENCE
LIBRARY