

香港大學校外課程手冊

一九七三年春季

SPRING PROSPECTUS

1973



**Extra Mural Studies**

**University of Hong Kong**

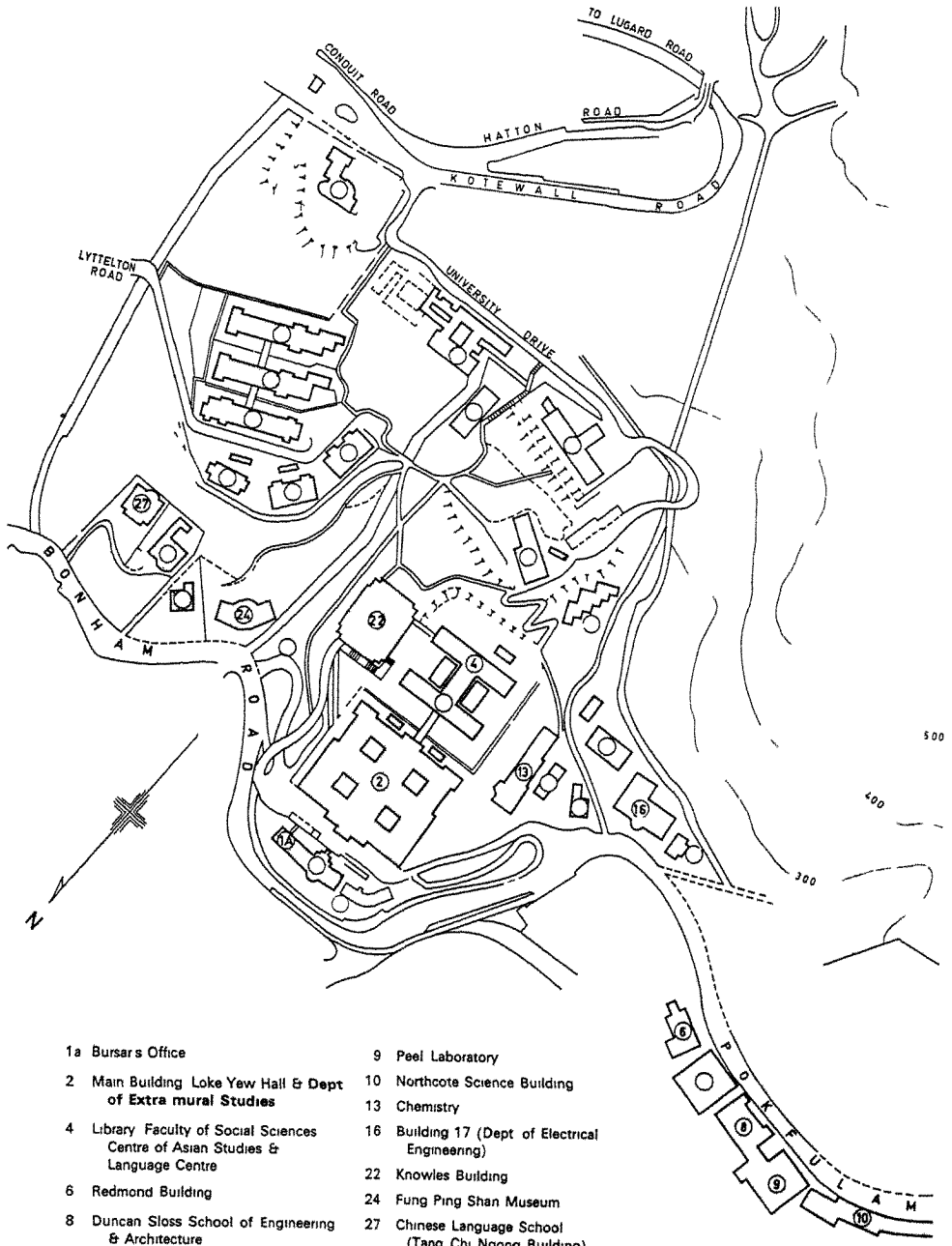

- |  |  |
|--|--|
| 1a Bursars Office  | 9 Peel Laboratory                                    |
| 2 Main Building Loke Yew Hall & Dept of Extra mural Studies                    | 10 Northcote Science Building                        |
| 4 Library Faculty of Social Sciences Centre of Asian Studies & Language Centre | 13 Chemistry   |
| 6 Redmond Building   | 16 Building 17 (Dept of Electrical Engineering)      |
| 8 Duncan Sloss School of Engineering & Architecture                            | 22 Knowles Building                                  |
|  | 24 Fung Ping Shan Museum                             |
|  | 27 Chinese Language School (Tang Chi Ngong Building) |

**UNIVERSITY OF HONG KONG GENERAL LAYOUT**  
 Please see inside of rear cover for enlarged plan of Main Building (2) and location of rooms



# **Extra Mural Studies**

**University of Hong Kong**

**DIRECTOR**

R. A. Williams, *M.A. (Wales)*

**SENIOR STAFF TUTORS**

K. N. Vaid, *B.Sc. (Punjab), M.A. (Delhi), Dip.S.W.P. (The Hague)*  
D. J. H. Macintosh, *M.A. (Cantab.), P.G.C.E. (Lond.)*

**ASSISTANT TO THE DIRECTOR**

Mrs. Priscilla Tso, *B.A., Dip.Ed. (H.K.), Dip.Ad.Ed. (Manc.)*

**STAFF TUTORS**

C. K. Leung, *M.A. (H.K.)*  
Jon A. Prescott, *B.Arch., M.C.D. (Liv.), Architect R.I.B.A., M.R.T.P.I.*  
T. W. Casey, *B.A. (Nott.)*  
Keith Sayer, *B.Sc. (Manc.)*  
Miss N. P. Lee, *B.A., Dip.Soc.St. (H.K.)*  
Neil Carr, *B.A. (Leic.), M.A. (W. Ontario), Dip.A.D. (Durh.)*  
J. P. Bensly, *B.A. (Oxford), M.A. (Reading)*  
John Russell, *B.Sc. (Lond.), M.I.S.M.*

**ASSISTANT STAFF TUTOR**

Wilson W. S. Ng, *M.Sc., Dip. Applied Microbiol. (Strath.)*

**SECRETARY**

Mrs. Yvonne Wong

## **SPECIAL COURSES**

The Department welcomes enquiries and requests from business organizations, government, voluntary bodies or private institutions for specially designed courses to meet their specific educational needs.

---

## **PRIOR ENROLMENT IS ESSENTIAL**

Failure to enrol prior to the opening of a particular course may mean the cancellation of that course. Prior enrolment is the only way the Department of Extra-Mural Studies has of judging the response to its courses. Your co-operation is therefore invited in sending your application forms to the Department as soon as possible.

## GENERAL INFORMATION

1. There are normally no entry requirements except that applicants should be over 18 years of age. Occasionally to have the full benefit of a course applicants must possess certain defined qualifications. Applicants are therefore advised to read the description of a course carefully. Professional courses usually have clearly defined entry requirements.
2. The Director may at his discretion refuse to admit an applicant.
3. Unless otherwise arranged, no Extra-Mural lectures will be held:
  - (a) on any public holidays.
  - (b) at a storm warning signal of No. 5 or above. (After the typhoon passes, if the No. 5 signal is lowered before 3 p.m., classes will take place as normal. If the signal is lowered after 3 p.m., classes will be cancelled that evening.)
  - (c) during the following holiday period: February 2-8, 1973, inclusive (Lunar New Year).
4. Fees are not refundable once the course has commenced.
5. Certificate of Attendance are issued, on payment of 50 cents, to those who have attended not less than two-thirds of a course of at least 20 meetings in duration.
6. Closing date for enrolment: one week before the starting date of a course. Late enrolments may not be accepted.
7. For enquiries, please ring either 5-468161 Ext. 307 or 308, or 5-450021 (3 lines), during office hours.

## HOW TO ENROL

8. Complete the attached enrolment form and mail it to the Director, Department of Extra-Mural Studies, University of Hong Kong. Forms are also available on request. To ensure that a class can take place, the Department would appreciate early enrolment by applicants.
9. You should send your application form together with the appropriate fee either in the form of a postal order, money order or crossed cheque made out in favour of the UNIVERSITY OF HONG KONG.
10. You will be notified if you are not admitted because of over-subscription or other reasons. THE DEPARTMENT WILL NOT NOTIFY SUCCESSFUL APPLICANTS WHO ARE EXPECTED TO ATTEND THE FIRST MEETING OF THE CLASS AT THE PLACE AND TIME ADVERTISED.
11. Applicants can also enrol in person at the following places:
  - (i) Department of Extra-Mural Studies, University of Hong Kong, University Main Building, Ground Floor, Pokfulam Road, Hong Kong (during office hours) (Buses Nos. 3, 4, 7, 23, 103). Tel: 5-468161 Ext. 307 or 308.
  - (ii) Extra-Mural Town Centre, Universal House, 11th Floor, 151 Des Voeux Road Central, Hong Kong. Tel: 5-450021 (3 lines) (entrance from Gilman Street). (From 10 a.m. to 8 p.m.)

## 入 學 須 知

1. 除特別規定學歷之課程外，祇需要年齡超過十八歲者，不限資格，均可申請入學。學員應詳閱課程簡介。
2. 學員被取錄與否，概由校外課程部主任審核報名申請書後決定之。
3. 除特殊情形外，本部在下列期間不授課：  
甲：本港公眾假期。  
乙：本港天文臺懸掛五號或以上風球之後。（颱風過後，如五號風球在下午三時以前除下，則照常上課，如風球在下午三時以後除下，則當晚課程全部取消。）  
丙：農曆新年假期：一九七三年二月二日至八日。
4. 課程開始後，學費通常不能退還。
5. 凡課程在廿講以上而學員上課次數超過三分之二者，得向本部繳費五角後申請發給聽講證書。
6. 學員應於開課一星期前報名，過期報名可能不被接受。又任何課程額滿後，即隨時截止報名，故學員應儘早報名。
7. 本部詢問電話：5-468161（內線 307 或 308）或 5-450021（3線）。

## 報 名 手 續

8. 填妥附於本手冊之報名申請書後，逕寄香港大學校外課程部主任收。申請書可隨時向本部索取。
9. 繳費可用支票，銀行本票，或郵政滙票，以「香港大學」名義抬頭，並加橫線，連同申請書逕寄香港大學校外課程部主任收。如用現金則請至本部繳納。
10. 如申請人已獲取錄，本部不再通知，可依時上課。如未獲取錄，則另函通知。
11. 申請人亦可親往下列地點報名：  
甲、香港大學校外課程部。  
薄扶林道香港大學正座地下（辦公時間內）。  
（下列各線巴士均經本部：3, 4, 7, 23, 103）。  
電話：5-468161（內線 307 或 308）。  
乙、校外課程部市區中心。  
香港德輔道中一百五十一號環球大廈十二樓（入口在機利文街）。（上午十時至下午八時）。  
電話：5-450021（3線）。

# CONTENTS

	Page
ARCHAEOLOGY - - - - -	7
ARCHITECTURE & PLANNING - - - - -	8
ART & DESIGN - - - - -	9
Fundamentals of Art & Design	
Industrial Design	
Practical Printmaking; Drawing and Painting	
COMMERCE & MANAGEMENT - - - - -	13
ECONOMICS & STATISTICS - - - - -	16
EDUCATION - - - - -	17
ENGINEERING - - - - -	19
ENGLISH STUDIES - - - - -	20
English for Teachers	
English Speech	
Spoken English	
English in Translation	
Critical Appreciation	
GEOGRAPHY & GEOLOGY - - - - -	24
LAW - - - - -	25
LIBRARIANSHIP - - - - -	26
ORIENTAL LANGUAGES - - - - -	27
Mandarin	
Cantonese	
ORIENTAL STUDIES - - - - -	29
PHILOSOPHY & PSYCHOLOGY - - - - -	30
POLITICAL SCIENCE - - - - -	32
SCIENCE & MATHEMATICS - - - - -	33
SOCIAL WORK & SOCIOLOGY - - - - -	35



# Archaeology

*Staff Tutor : Jon A. Prescott, Telephone 5-450021*

**164. A Review of the Prehistory of Hong Kong.** James C. Y. Watt, M.A. (Oxon.). Curator, Art Gallery and Museum. Institute of Chinese Studies, Chinese University of Hong Kong. *Wednesdays, 6.00-8.00 p.m., starting February 14, 1973. Extra-Mural Town Centre. 3 meetings. Fee: \$30*

Mr. Watt will review the prehistory of Hong Kong as currently accepted in the light of recent research and various discoveries in mainland China and in S.E. Asia generally. Particular reference will be made to contributions to knowledge made by new material found in Thailand as well as the new ideas generated by mainland finds, which the lecturer has just visited.

Preference will be given to those people who have attended Dr. Bard's basic course in previous years. Please state on your application if you have attended one of these courses.

*Enrolment will be limited to 25 persons to allow time for discussion. This course was postponed from last term because of the absence of the tutor from the Colony.*

## UNIVERSITY ENTRANCE

The attention of extra-mural students is drawn to the following regulation of the University of Hong Kong regarding admission to the University:

'A mature person without formal academic qualifications who is aged 30 or over on September 1 of the year in which admission is sought may be exempted completely from University entrance requirements but shall not be eligible for admission to the Faculty of Medicine.'

Enquiries about this exemption clause should be addressed to the Registrar, University of Hong Kong.

# Architecture & Planning

*Staff Tutor* : Jon A. Prescott, Telephone 5-450021

*The programme of Seminars for Architectural Studies is presented in joint sponsorship with the Hong Kong Institute of Architects, an allied Society of the Royal Institute of British Architects, London.*

**165. Architecture & Insurance Policies.** *Wednesday, 5.30-10.30 p.m., February 21, 1973. Club Lusitano, 11th floor, Duddell Street. Fee: \$40*

A series of papers and discussion on related topics involving insurance problems and the position of the professional man.

This seminar is planned as a follow up to the highly successful one on the law and the professional man and will follow the same pattern. The fee includes dinner.

Bar service will be available from 5.30 p.m. and the first speaker will commence at 6.00 p.m.

For full details, please contact Mr. Jon A. Prescott, 5-450021.

**166. Current Hong Kong Housing Problems.** B. F. Will, B.Arch. M. Urb. Studies (Queensland). Chairman. *Mondays, 6.00-8.00 p.m., starting February 12, 1973. Extra-Mural Town Centre. 10 meetings. Fee: \$100*

A series of seminars will debate the significant Hong Kong Housing issues arising from the present situation in conjunction with Government's new outline housing policy. A number of high level public servants who work in the housing field have been invited to lead the discussion at different meetings, and a wide cover ranging over planning and construction, system building, management problems and social and economic aspects will be aimed at.

The seminars will be by invitation, but limited places for others interested will be available. The fee for the forum includes light refreshments. Please contact the Staff Tutor for further details. 5-450021.

# Art & Design

*Staff Tutor* : Jon A. Prescott, *Telephone* 5-450021

## **167. Certificate Course in Fundamentals of Art & Design**

A daytime course extending over one and a half years of 4 terms of 10 weeks duration. Formal instruction is concentrated into three or four days per week, but considerable additional private work will be necessary.

The object of this foundation level course is to provide a range of studies and understanding which will enable students, whatever the nature of their previous education, to gain an opportunity to develop talents and discover interests in the field of Art & Design.

**Fee: \$2000**

*Enrolment is limited to 25 persons.*

*Entry Requirements*: Consideration will be given to those who have an interest in Art & Design and proficiency in English up to at least the level of the Hong Kong English School Certificate, Grade E.

The syllabus outline is as follows:

1. Consideration and evaluation of Visual Criteria.
2. History of Western Art and Architecture with concentration on 19th and 20th centuries. History of Oriental Art and Architecture, including techniques.
3. An understanding of Man as an individual, and Man in Society in relation to Design expression.
4. Understanding of the Nature of Materials and Visual and Tactile relationships and values. Colour theory.
5. Drawing Techniques both free and mechanical, Life Drawing.
6. Studio: Two Dimensional Studies ranging from Painting to Print-making.
7. Studio: Three Dimensional Studies ranging from Sculpture and Construction to Design problems.

The course consists of formal lectures, seminars and discussions and considerable studio work.

*Director of Studies* :

Jon A. Prescott, B.Arch., M.C.D., Architect R.I.B.A., M.R.T.P.I.

*Advisory Panel* :

Michael F. Griffith, A.T.D.

Kwok Chiu Leung, Dip. A.D.

Kwong Yeu Ting, M.Sc. (Kansas)

Henry Steiner, M.F.A. (Yale)

John Warner, A.T.D., N.T.D.

*Course Tutors and Visiting Critics :*

Ruth H. Addison, Dip.Arch., Architect R.I.B.A.  
Chang, Juncan, A.A.Dip. Architect R.I.B.A.  
Cheung Yee, B.F.A.  
David W. Crowe, Dip.Arch., Architect R.I.B.A.  
Michael F. Griffith, A.T.D.  
R. Clemens, B.A. (Fine Art) Melbourne, Dip.Ed.  
Werner Hahn, Dip. Graphic Design (Fachoberschule Nirnberg)  
Erik Kvan, Cand. Theol. (Copenhagen)  
Tao Ho, B.A. (Williams), M.Arch. (Harvard), Architect H.K.I.A.  
Diane Hughes, Dip.A.D. (Camberwell), A.T.C. (Hornsey)  
Martha Lesser, B.S. (N.Y.U.)  
John Nye, Dip.Art (Fine Art), R.M.I.T., T.T.T.C. (Australia)  
Elize Parkin, N.D.D., A.T.D. (Liverpool)  
Pao, Cissy, B.A., B.F.A. (Washington)  
Lawrence C. S. Tam, B.A. (Hons.) (London), M.A.  
B. S. Vaughan, D.C.

For full details of the course arrangements, syllabus and any other information, please contact the Director of Studies, Tel. 5-450021 or c/o Extra-Mural Town Centre.

*Applications for Entry must be received before January 30, 1973 and candidates will be called for interview.*

*Instruction will commence during the week commencing February 18, 1973.*

**Post-graduate Course in Industrial Design**

Reference is made to the Post-graduate course in Industrial Design which was advertised in the main brochure in August 1972.

Applications for this course must be submitted before February 11, 1973.

Please contact Staff Tutor in-charge for further information.

# PRACTICAL PRINTMAKING; DRAWING AND PANTING

*These are practical classes in the visual arts with emphasis on imaginative painting or drawing, designed to encourage growth of individual creative powers. Work will be carried on in the various media described. Instruction is individual as classes are restricted in size. Enrolment is open to students at different stages, beginners being particularly welcome.*

*Materials will be discussed at the initial meeting in each class and students must provide all materials necessary or buy the same through the department.*

*In cases where a model is used an additional fee will be charged.*

**168. Painting in Oil & Acrylic.** Miss Cissy P. L. Pao, B.A., B.F.A. (Washington). *Tuesdays, 6.00-10.00 p.m., starting February 13, 1973. Extra-Mural Town Centre. 20 meetings.* **Fee: \$280**

Although the concentration of effort in this course will be on painting, there will be an introductory period of analysis of alternate ways of perception, of consideration of the subject matter of a painting in terms of tone, line or volume as well as examination of fundamental colour relationships. The course is designed for beginners and will include instruction in the preparation of canvases and choice of materials, which students will be expected to provide themselves.

*Enrolment will be limited to 20 persons.*

**169. Life Drawing.** Michael F. Griffith, A.T.D. *Thursdays, 6.00-8.00 p.m., starting February 15, 1973. Extra-Mural Town Centre. 10 meetings.* **Fee: \$100**

A course in life drawing from the model. Development of individual techniques will be encouraged and the acquisition of a basic knowledge of anatomy regarded as essential.

An additional fee of \$25 will be charged for the model.

**170. 版畫製作：石版畫與金屬蝕刻**  
**(Printmaking: Lithography and Etching)**

主 講 人：鮑蓓麗女士，楊周綠雲女士。

地 點：蔣扶林香港大學畫廊。

時 間：一九七三年二月十日起，每星期六下午二時至六時。

學 費：四百五十元。

本課程包括利用幻燈照片討論現代藝術家之作品，探討繪畫基本技術與各種版畫物料之關係，使學員能適當地運用版畫製作方法，以配合個別思想發展。本科大部份時間將用作實習，教授語言中英並用，學員將有接受個別指導之機會。

學員須自備用品及繳交廿五元油墨及印輪等之費用。

名額限廿人。

**PRIOR ENROLMENT IS ESSENTIAL**

Failure to enrol prior to the opening of a particular course may mean the cancellation of that course. Prior enrolment is the only way the Department of Extra-Mural Studies has of judging the response to its course. Your co-operation is therefore invited in sending your application forms to the Department as soon as possible.

# Commerce & Management

*Staff Tutor : John Russell, Telephone 5-468161 Ext. 309*

*The courses in this section are aimed at all levels of industry, commerce and the public service. They are designed for two types of student :*

- (a) Those who wish to prepare for professional examinations.*
- (b) Those who wish to acquire skills and knowledge appropriate to their present responsibilities and future development.*

*Some courses are more advanced than others and require prior participation in basic courses for admission. In particular, students are advised not to enter for courses geared to examination requirements unless they already have a basic knowledge of the subject and fully intend to take the examination.*

*There will be other courses arranged during the year at the request of professional societies and industrial firms for which details cannot now be given. Suggestions or proposals for courses are welcome. The Department is always willing to consider arranging special courses for members of a particular firm or organisation or for a group of such bodies.*

**171. Structure of Commerce.** Neil Carr, B.A., M.A., Dip.A.D., Fridays, 7.00-8.30 p.m., starting February 23, 1973. Lecture Room South, 8/F., City Hall. 6 meetings. **Fee: \$45**

Subjects to be discussed in this course include the nature and scope of commercial activity, the main commercial functions, including exchange, transport and storage, finance, risk-bearing. Supply and demand, and their effect on price under conditions of competition and monopoly. Money, bills of exchange, methods of payment and foreign exchange. The balance of payments and International Trade. Banks and their main services. Business ownership, control, the provision of capital, its use and the relationship of capital, stock, turnover, expenses and profit.

This course is specifically related to the needs of candidates who intend to take the Part I Examination for Associateship of the Institute of Chartered Shipbrokers.

**172. An Introduction to Law for the Businessman.** Raymond Faulkner, B.A. (Cantab.), Barrister-at-Law, Lecturer in Law, University of Hong Kong. Mondays, 8.15-9.45 p.m., starting February 12, 1973. Extra Mural Town Centre. 12 meetings. **Fee: \$60**

This course is intended for businessmen for whom a knowledge of the Law as it relates to the various activities in a business enterprise would be useful or desirable. Subjects to be discussed include Company Law, Contract, and the Law relating to the employment of persons: law affecting the Sale of Goods, Hire and Purchase, Bills of Exchange and Contracts of Carriage. No previous knowledge of law will be assumed.

**173. Practical Aspects of Taxation.** J. K. S. Thong, F.A.C.C.A., F.C.I.S. *Thursdays, 8.15-9.15 p.m., starting February 15, 1973. Extra Mural Town Centre. 15 meetings.* **Fee: \$60**

The principles of assessing incomes liable to taxation and the problems arising. The various functions of the Departments of the Inland Revenue including the duties and powers of the Assessors, the Board of Inland Revenue and the Board of Review. The practical problems of submitting tax returns, expenses, claims and appealing against tax assessments. It is suitable for business executives as well as those wanting a basic knowledge of how taxes on corporations and individuals are levied and paid.

**174. 銀行實務(二)**  
**(Practical Banking II)**

主 講 人：陳天元先生。

講授語言：粵語。

地 點：香港大學校外課程部市區中心。

時 間：一九七三年二月十九日起每星期一下午七時至八時。

學 費：四十五元。

本課程共十二講，繼續講述銀行實務，特別注意進出口押匯及跟單商業信用證。關於香港新銀行條例，中央銀行及其他重要問題，亦加以研討。

**175. 投資學(二)**  
**(Investment II)**

主 講 人：李舜兒碩士。

講授語言：粵語。

地 點：香港大學校外課程部市區中心。

時 間：一九七三年二月十四日起每星期三下午五時四十五分至六時四十五分。

學 費：六十元。

這科高級投資課程將包括證券的本身基本情形及股市趨勢分析。損益表以及資產負債表將會作深入的研究及分析。並特別注重各種工業股票之市價與盈利比率。個別行業之基本分析，買賣以及劃線表之走勢及技術性之研究。（共十四講）。



**176. 投資設廠研究**  
**(Industrial Investment)**

主 講 人：王文敦碩士。

講授語言：粵語（學員自備參考書）。

地 點：香港大學校外課程部市區中心。

時 間：一九七三年二月廿二日起每星期四下午八時十五分至九時四十五分。

學 費：七十元。

本課程共十三講，主要內容包括投資設廠各問題。例如：設廠計劃之編製；經營行業與主要產品種類的選擇；產品設計問題；工藝規程問題；生產規模問題；廠房型式之選擇與廠房設計；設廠地區，地址之選擇；工廠結構問題；車間組織設計；廠址總體設計等。

**177. Starting A New Business Enterprise.** William Cheng, B.S. (Caltec), M.B.A. (Harvard). *Tuesdays, 6.00-7.30 p.m., starting March 6, 1973. Extra Mural Town Centre. 8 meetings.* **Fee: \$75**

This course will survey basic elements and characteristics of entrepreneurship and is designed for people who have embarked on a new business enterprise or are about to start up their own business. Various development stages of the enterprise will be discussed: planning, preparation, procedures for establishment, managerial and administrative practices and expansion. The emphasis will be placed upon the practical aspects of starting a new business venture and the ways of solving problems which commonly occur in such an undertaking.

*Diploma in Management Studies*

The Department of Extra-Mural Studies is responsible for this two-year part-time day release University Diploma which is offered to graduates or other suitably experienced and qualified candidates. Those selected will be expected to attend for two evenings per week and to be given release by their employers for one afternoon per week over the two year duration of the course. Applications for the 1973 September intake to the first year of this course should be sent to the Department by no later than June 9, 1973. Further details of the content of this Diploma course may be obtained by writing to Mr. J. Russell, Department of Extra-Mural Studies, University of Hong Kong.

# Economics & Statistics

*Staff Tutor : Neil Carr, Telephone 5-468161 Ext. 304*

**180. Money and Balances of Payment.** M. E. Morkre, B.A. (Redland), Ph.D. (Northwestern), Senior Lecturer in Economics, University of Hong Kong. *Tuesdays, 6.15-7.15 p.m., starting February 13, 1973. University Main Building. 20 meetings. Fee: \$100*

The course proposes to study, from a relatively non-technical standpoint, the relationship between the operation of an economy's monetary system and its international trade and transfer activities. Emphasis will be placed on the Hong Kong economy and when possible illustrations and examples will be given. A sample of the experiences of other countries, in particular some of Hong Kong's major trading partners will be taken up as well. Candidates will need the equivalent of A-level economics plus either further academic work or relevant business experience.

**181. Introduction to Statistics.** Ho Fong Hoe, B.A. (H.K.), Demonstrator in Statistics, University of Hong Kong. *Wednesdays, 7.00-8.00 p.m., starting February 21, 1973. Extra Mural Town Centre. 10 meetings. Fee: \$50*

This course conveys a basic understanding of the elements of statistics and of the range of applications. The object is to establish firmly the bridge between the elementary treatment of a first course in statistics and the rigorous treatment given in more advanced university courses. The key of the course is the learning of the common methods of classifying and representing data.

**182. Methods of Operational Research.** Ho Fong Hoe, B.A. (H.K.), Demonstrator in Statistics, University of Hong Kong. *Tuesdays, 5.30-7.00 p.m., starting March 27, 1973. Extra Mural Town Centre. 16 meetings. Fee: \$100*

This course introduces some important and useful concepts in operational research; it also serves as a stepping stone for further studies in this rapidly growing field. It will deal with linear programming; allocation problems: the assignment and distribution of resources; replacement and maintenance problems; inventory control and production scheduling; network analysis; sequencing problems; and critical path analysis.

Participants in this course are expected to have a basic knowledge of algebra and calculus.

# Education

*Staff Tutor: C. K. Leung, Telephone 5-468161 Ext. 306*

**183. Modern Educational Techniques: Topics for Practising Teachers.** N. K. Henderson, Ph.D. (London), B.A., M.Ed. (Melb.), A.B.Ps.S., F.C.P., Professor of Education, University of Hong Kong. *Thursdays, 6.00-7.30 p.m., starting February 15, 1973. Room 121, University Main Building. 10 meetings.* **Fee: \$60**

This course is in part a refresher course for teachers, and in part an opportunity to introduce to Hong Kong teachers some new thinking in the areas of school administration, teaching procedures and school guidance and counselling methods. Although mainly concerned with secondary schools, the lectures and demonstrations will also have much of interest for upper primary school teachers. The results of recent experiments and research will be studied at some stages, but attention will be mainly given to Hong Kong school needs and local teachers' problems: pupils' problems and promoting better study habits will also be treated. There will be films, full sets of printed notes will be issued, and ample opportunities for questions and discussions will be provided.

**184. 低能(智力)兒童的管教**  
**(Understanding and Helping the Mentally Handicapped Child—An Appreciation of the Problem)**

主 講 人：由香港低能兒童及青年教育協進會行政秘書鄧福泉先生及本港對低能兒童有研究及直接工作經驗之專業人士擔任。

講授語言：粵語。

地 點：香港大學校外課程部市區中心。

時 間：一九七三年二月十五日起每星期四下午六時至七時三十分。共十四講。

學 費：八十五元。

本課程之目的為使社會人仕、家長、及直接為低能兒童工作之教師、護士、社會工作者、或訓導員，對低能兒童有基本之了解，並在管教方面，有正確之認識。

課程內容包括緒論，社會對低能兒童之照顧，低能兒童之成因及本質（包括醫療方面），低能兒童之需要，及其在家庭，學校，社會及職業方面之適應問題，教育問題，職業訓練等等。講授方面以粵語為主。方式包括專題講座，電影，討論，參觀低能兒童訓練機構等。限收三十名。在職專業者及兒童家長將獲優先取錄。

（本課程由香港低能兒童及青年教育協進會贊助）

**185. Topics in Sixth Form Chemistry—3. A Mechanistic Approach to Organic Chemistry.** *Wednesdays, 6.00–7.30 p.m., starting February 14 1973. Chemistry Building, University of Hong Kong. 8 meetings. Fee: \$80*

*Tutors:* Dr. M. J. K. Lie, Lecturer in Chemistry, University of Hong Kong.  
Dr. K. F. Cheng, Lecturer in Chemistry, University of Hong Kong.  
Mr. R. T. Allsop, Lecturer in Education, University of Hong Kong.

This short course is designed to provide an introduction to the study of organic chemistry via a mechanistic approach. It is designed for teachers of sixth-form chemistry.

The course will attempt to treat two distinct aspects of the topic, firstly from the view point of furthering the personal chemical education of the participants, and secondly from the view point of possible applications of the topic to the sixth-form context. The planned changes in the Hong Kong University Advanced Level Chemistry syllabus will bring this approach to Organic Chemistry within the compass of the sixth-form teacher for the first time.

The course will consist of a series of lectures and tutorials, eight in all. Additionally there will be objective-type questions and simple programmed units to be completed during the course. It has been designed initially for those teachers with little or no background in mechanistic approaches, but the small group tutorials should allow more advanced discussion if there is a demand for it.

**Fee Refund:** *Teachers of Chemistry at Advanced Level who wish to have their fees refunded by the Director of Education are required to complete an application form (obtainable from the Department of Extra-Mural Studies, University of Hong Kong) which must be returned directly to the Director of Education before the commencement of the course. This applies to all teachers whether in government, aided or private schools.*

*See also:*

**189. English Teaching Techniques.** (Page 20)

**219. Secondary School Mathematics for Teachers.** (Page 34)

# Engineering

*Staff Tutor : Mrs. Priscilla Tso, Telephone 5-468161 Ext. 303*

**186. Controlled Power Conversion.** S. K. Tso, B.Sc. (Eng.) (H.K.), M.Sc., Ph.D. (Birm.), C.Eng., M.I.E.E., Lecturer in Electrical Engineering, University of Hong Kong. *Fridays, 7.00-9.15 p.m., starting February 16, 1973. Lecture Room, Department of Electrical Engineering, University of Hong Kong. 8 meetings.* **Fee: \$75**

Outline of syllabus: implementation and control of a.c./d.c. rectification, d.c./a.c. inversion, a.c./a.c. frequency changing and d.c./d.c. transformation; rotating and static conversion devices; industrial applications.

It is assumed that applicants have reached CEI Part I standard or equivalent.

**187. Introduction to Microelectronics.** M. T. Brian, M.Sc., Ph.D. (Birm.), M.Inst.P., Lecturer in Electrical Engineering, University of Hong Kong. *Tuesdays, 6.30-8.45 p.m., starting February 20, 1973. Lecture Room, Department of Electrical Engineering, University of Hong Kong. 10 meetings.* **Fee: \$90**

Outline of syllabus: basic semiconductor physics; physics of device operation; device fabrication techniques; discrete and integrated components; integrated circuit design; mass production principles.

**188. Measurement and Instrumentation.** Paul Yu, M.S.E.E. (Ill.), Ph.D., Mem.I.E.E.E., President, At-Yu Electronics Corp., Ltd., and Manager, Advance Research & Development, Atlas Electronics Corp., Ltd. *Tuesdays, 6.30-8.30 p.m., starting February 20, 1973. Room A, Building 17, University of Hong Kong. 10 meetings.* **Fee: \$90**

This course is designed for practising engineers in the electronic industry to familiarize them with the necessary basic and practical tools in measuring components, circuits and devices.

Outline of syllabus: general tools and techniques; measuring voltage, current, phase and frequency; measuring passive components (R, C, L, Z) and active devices (diodes, transistors, FET, MOS, SCR, IC etc.); waveform analysis and distortion measurement; digital instrumentation; measurement and alignment in AM, FM-Multiplex, and TV Receivers.

It is assumed that applicants have reached CEI Part I standard or equivalent.

# English Studies

*Staff Tutor* : D. J. H. Macintosh, *Telephone* 5-456443

## ENGLISH FOR TEACHERS

**189. English Teaching Techniques.** William Cheng, B.A., M.A. (Ed.) (H.K.), Dip. in App.Ling. (Edin.). *Tuesdays, 6.30-8.00 p.m., starting February 13, 1973. University Main Building. 12 meetings. Fee: \$80*

Planned to assist secondary school teachers of English, this course will deal with up-to-date techniques applicable to the most important areas of the curriculum. The basic principles of language teaching will be discussed in detail with particular relation to the following topics:

1. The teaching of vocabulary;
2. The teaching of reading;
3. The teaching of English grammar;
4. The teaching of oral and written English;
5. The presentation of set books and the teaching of poetry;
6. Language testing.

The tutor is Principal, New Territories Heung Yee Kuk Yuen Long District Secondary School and a former lecturer in English at Sir Robert Black College of Education.

**Fee Refund:** *Teachers of English at Advanced or Certificate of Education levels who wish to have their fees refunded by the Director of Education are required to complete an application form (obtainable from the Department of Extra-Mural Studies, University of Hong Kong) which must be returned directly to the Director of Education before the commencement of the course. This applies to all teachers whether in Government, aided or private schools.*

## ENGLISH SPEECH

**190. Pronunciation Correction and Speech Training.** Raymond Huang, B.A. (Lingnan), M.A. (Leeds), I.P.A.Cert.Phon., P.G.C.E., L.R.A.M., L.T.C.L. *Mondays, 7.00-8.30 p.m., starting February 12, 1973. City Hall Committee Room South. 16 meetings. Fee: \$100*

Tuition will be aimed at eradicating common errors in English Speech, articulation and intonation and rhythm. The basic causes of the difficulties that are encountered by Cantonese-speaking students will be analysed, methods of correction suggested and graded and aural-oral exercises provided.

The tutor is Principal, Queen's College and formerly Principal, Sir Robert Black College of Education. He is also author of a number of books on Phonetics, including *English Pronunciation Explained with Diagrams* and *English Speech Training*.

**191. Advanced Oral Communication.** Kenneth Method, English Language Teaching Adviser, Longman Group (Far East) Ltd. *Mondays and Wednesdays, 6.15-7.45 p.m., starting March 5, 1973. Wah Yan College, Queen's Road East. 10 meetings.* **Fee: \$70**

The tutor will help the students to analyse a selection of fairly typical conversations in relation to frequently recurring situations, and then provide them with related material that they will reproduce in conversations that will take place in class. Particular attention will be paid not only to *what* is said, but also to *how* it is said in relation to the western cultural environment. The emphasis will therefore be on the implications of intonation, tone of voice, gesture and facial expression.

This course is intended for those who, although they may have a good passive command of English, feel that they need guidance and further practice in everyday conversations with westerners. It is not therefore intended for those whose spoken English is weak or who are looking for a basic course in pronunciation. Enrolment is limited to those who are best qualified to benefit from the course and participate in it, and the final selection may be by interview.

## SPOKEN ENGLISH

In all these courses modern language laboratory teaching methods will be used to give the maximum opportunity for speaking English. The tuition in Spoken English I will be aimed at improving the students' pronunciation and intonation and giving them plenty of opportunity in asking and answering oral questions. In Spoken English II the emphasis will be on conversational English in different situations.

The tutors for all these courses will be drawn from a panel of university graduates.

In order to allow the tutors to pay the maximum amount of attention to individual students, enrolment is limited to 15 persons in each course and may be by selection of those best qualified to benefit from the courses. Preference will be given to applicants attending a Use of English course or those who have completed one.

All the courses will be held in the language laboratory of the Language Centre at Hong Kong University.

### **Spoken English I. 10 meetings.**

**192.** *Tuesdays, 6.30-8.00 p.m., starting February 13, 1973.* **Fee: \$45**

**193.** *Thursdays, 6.30-8.00 p.m., starting February 15, 1973.* **Fee: \$45**

### **Spoken English II. 10 meetings.**

**194.** *Fridays, 6.30-8.00 p.m., starting February 16, 1973.* **Fee: \$45**

## ENGLISH IN TRANSLATION

The importance of English/Chinese and Chinese/English translation is daily becoming more evident. The Department of Extra-Mural Studies therefore offers courses in this skill at two levels. The first of these is intended for those who have had little or no experience of it and the second for those who have completed the first course satisfactorily. In both courses the teaching will be directly related to the translation needs of Hong Kong, and in the second course considerable attention will be paid to the translation of technical and legal terms.

On completion of the first course students may sit a test which, if they pass satisfactorily, will qualify them to proceed to the second course. Those who complete both courses consecutively may apply for a Certificate of Attendance. *As these two courses together comprise a continuous programme, applicants for English in Translation II will not normally be accepted unless they have previously completed English in Translation I satisfactorily.*

The tutor, who has had considerable experience of teaching translation methods in Hong Kong, Singapore and Taiwan, was previously employed by International Agencies of the United Nations as a translator.

**195. English in Translation I.** Jao Yu Wei, M.A. (Edin.). *Mondays, 6.30-8.00 p.m., starting February 12, 1973. University Main Building. 16 meetings.* **Fee: \$100**

**197. English in Translation II.** Jao Yu Wei, M.A. (Edin.). *Wednesdays, 6.30-8.00 p.m., starting February 14, 1973. University Main Building. 16 meetings.* **Fee: \$100**

## CRITICAL APPRECIATION

**198. Reading and Discussion.** Mrs. Jane Ram, B.A. (Dunelm). *Tuesdays, 6.15-7.45 p.m., starting February 13, 1973. Wah Yan College, Queen's Road East. 10 meetings.* **Fee: \$60**

A further course, principally intended for those who have completed the 'Use of English II' course or who are following it this year, but also suitable for those others who have a full command of English. Various types of non-literary English, including newspaper reports, editorials and articles will be examined critically and discussed in class.

Textbook: W. E. K. Anderson: *The Written Word* (O.U.P.). This book may be obtained from the Hong Kong Book Centre, Des Voeux Road Central.



**199. Our Region in English Literature.** Miss G. Workman, B.A., M.Litt. (Bristol), Lecturer in English, University of Hong Kong. *Thursdays, 6.30-8.00 p.m., starting February 15, 1973. University Main Building. 10 meetings.* **Fee: \$60**

Hong Kong, like other countries in the region, has caused a number of authors to write about their experiences in relation to the culture of the host country.

This course will consider various novels written about experiences in China, Burma, Malaysia, Vietnam, Ceylon and Australia as well as Hong Kong. Han Suyin's novel, *A Many Splendoured Thing* will be included as a point of comparison.

The following novels will be considered during the course:

1. A. Burgess: The Malayan Trilogy;
2. J. Clevell: Taipan;
3. E. M. Forster: A Passage to India;
4. Han Suyin: A Many Splendoured Thing;
5. L. Hearn: Japanese Miscellany;  
Kwaidan Stories;
6. G. Greene: The Quiet American;
7. D. H. Lawrence: Kangaroo;
8. W. S. Maugham: A Painted Veil;
9. George Orwell: Burmese Days.

These books will be available for sale in Hong Kong before the course begins. Information as to where they may be obtained will be distributed to all who enrol.

A selection of short stories by Somerset Maugham and George Orwell will also be distributed during the course.

# Geography & Geology

*Staff Tutor : C. K. Leung, Telephone 5-468161 Ext. 306*

## 200. 統計地理學 (Statistical Geography)

主 講 人：羅楚鵬博士。

講授語言：粵語（輔以英語）。

地 點：香港大學校外課程部市區中心。

時 間：一九七三年二月二十八日起每星期三下午五時  
四十五分至六時四十五分。共十講。

學 費：三十五元。

近代地理學極端重視數學方法的應用。其中尤以統計學的方法，在解答單元性及多元性或空間分析性的地理學問題上，有更多樣化而有趣的應用。本課程的目的在給予未曾接受過統計學訓練的地理學者及教師一些有關統計學的基本概念。內容包括：  
（一）地理資料的特徵，（二）類數分佈，（三）集中趨勢的量定，（四）標準差異之量定，（五）概率論，（六）統計模式，（七）抽樣，（八）估計，（九）假設之測定，及（十）相關與迴歸分析等等。

限收三十人。

**201. Introduction to Urban Geography.** C. K. Fung, B.A. (H.K.), Demonstrator in Geography, University of Hong Kong. *Tuesdays, 8.00-9.30 p.m., starting February 27, 1973. Extra-Mural Town Centre. 8 meetings plus 2 weekend trips.* **Fee: \$60**

The course is designed to provide a brief introduction to this remarkably diverse and rapidly growing field. Topics of discussion will include the various theories about the growth, location, spacing, size and internal structure of urban settlements, and the different aspects of the urbanization process as observed in both the developed and the developing worlds. Hong Kong examples will be used wherever feasible. Some lectures will be illustrated with slides.

*See also :*

**166. Current Hong Kong Housing Problems.** (Page 8)

**217. An Outline of Stellar Astronomy.** (Page 33)

# Law

*Staff Tutor* : Mrs. Priscilla Tso, *Telephone* 5-468161 *Ext.* 303

## 202. 市民與法律 (Law and the Citizen)

主 講 人：韓譚春先生。

講授語言：粵語。

地 點：香港大學校外課程部市區中心。

時 間：一九七三年二月十六日起每星期五下午五時卅分至七時。

學 費：五十五元。

本課程共十五講，每週一次，旨在引起市民對法律之興趣與認識。主要內容包括：

(一) 本港法庭的司法程序，律師和法庭的種類。

(二) 政府的法律援助。

(三) 刑事法和民事法的分別，民事不法行爲的訴訟，誹謗和疏忽等。

(四) 道路交通法例。

(五) 勞工和僱傭法例。

(六) 合約的種類，成立和實行。

## 203. 住客與業主 (Landlord and Tenant)

主 講 人：韓譚春先生。

講授語言：粵語。

地 點：香港大學校外課程部市區中心。

時 間：一九七三年二月十九日起每星期一下午八時至九時三十分。

學 費：三十元。

本課程共六講，目的在使市民認識香港現行法律對業主和住客的保障，着重說明土地支配權及樓宇的買賣手續。

*See also* :

**172. An Introduction to Law for the Businessman.** (Page 13)

# Librarianship

The following courses are offered annually, commencing early September.

*Librarianship : Intermediate Part I Course.* This course is designed for those wishing to take up Librarianship as their profession. The course, of 11 months' duration, prepares candidates for the December 1974 United Kingdom Library Association Intermediate Part I Examination.

*Certificate Course for Library Assistants.* The course is planned in co-operation with the Hong Kong Library Association and is designed to provide a non-professional training for Library Assistants and those working in school, children or government department libraries or are otherwise interested in the subject. Successful candidates will be awarded a Certificate issued jointly by the Hong Kong Library Association and the Department of Extra-Mural Studies.

For further particulars regarding entry requirements, course content, application forms etc, please write to Mrs. Priscilla Tso, Department of Extra-Mural Studies, University of Hong Kong. Applications for 1973-74 must be submitted before September 7.

# Oriental Languages

*Staff Tutor* : C. K. Leung, Telephone 5-468161 Ext. 306

*The Oriental Languages programme is taught in English, Mandarin and Cantonese as described. A good standard in the appropriate medium is essential to gain full benefit from the course.*

*Laboratory assistance for Mandarin I, Kuo Yu I, and Cantonese I/II, is available at Caritas House, Caine Road, at \$25 per 12 hours of study. Students of these courses, however, will be given free of charge one hour of conducted laboratory exercise during course time to familiarise themselves with the system.*

## MANDARIN

**204. Mandarin I.** L. T. Tan, B.A. (Nat. Chi-nan). *Mondays and Thursdays, 7.30-8.30 p.m., starting February 19, 1973. University Main Building. 50 meetings plus 1 lab. session.* **Fee: \$250**

The main emphasis of this course will be on spoken Mandarin and ample opportunity will be given for practising pronunciation and short sentence construction orally.

Textbook: *Beginning Chinese* by John de Francis, Yale University Press.

### 205. 初級國語 (Mandarin I)

主 講 人：白選之先生。

講授語言：粵語。

地 點：香港大學校本部。

時 間：一九七三年二月二十日起每星期二及星期五下午六時十五分至七時十五分。共五十一講。

學 費：一百七十元。

本課程共五十一講(包括錄音室練習一小時)，每週二講，每講一小時。內容有國語注音符號(包括注音字母及大陸現行標準拼音法)，國、粵語發音，語法和詞句的差異，國語會話和文章選讀等。

## CANTONESE

### *Cantonese I*

The main emphasis of this course will be on basic grammar in spoken Cantonese and ample opportunity will be given for practising pronunciation and short sentence construction orally.

Textbook: *Speak Cantonese, Book I* by Parker Po-fei Huang and Gerard P. Kok, Yale University Press.

**206. Cantonese I.** Francis Sham, B.A. (Sun Yat-sen), Instructor in Chinese. *Mondays and Thursdays, 2.00-3.00 p.m., starting February 19, 1973. Extra-Mural Town Centre. 50 meetings plus 1 lab. session. Fee: \$250*

**207. Cantonese I.** C. S. Hung, B.A. (Chinan), Instructor in Chinese, University of Hong Kong. *Tuesdays and Fridays, 6.15-7.15 p.m., starting February 20, 1973. University Main Building. 50 meetings plus 1 lab. session. Fee: \$250*

### *Cantonese II*

This course, intended for students who have completed Cantonese I or who can prove that they have had equivalent training in Cantonese, will concentrate on oral expressions and idioms.

Textbook: *Speak Cantonese, Book I* by Parker Po-fei Huang and Gerard P. Kok, Yale University Press.

**208. Cantonese II.** Francis Sham, B.A. (Sun Yat-sen), Instructor in Chinese. *Tuesdays and Fridays, 2.00-3.00 p.m., starting May 1, 1973. Extra-Mural Town Centre. 30 meetings plus 1 lab. session. Fee: \$180*

**209. Cantonese II.** C. S. Hung, B.A. (Chinan), Instructor in Chinese, University of Hong Kong. *Mondays and Thursdays, 6.15-7.15 p.m., starting April 30, 1973. University Main Building. 30 meetings plus 1 lab. session. Fee: \$180*

# Oriental Studies

*Staff Tutor* : C. K. Leung, *Telephone* 5-468161 *Ext.* 306

## 210. 香港的過去、現在和將來 (Hong Kong's Past, Present and Future)

主 講 人：伍宗唐碩士，李岳博士，梁志强碩士，陳坤耀  
碩士，葉富強碩士。

講授語言：粵語。

地 點：香港大學校外課程部市區中心。

時 間：一九七三年三月二日起每星期五下午五時四十  
五分至六時四十五分。共十講。

學 費：三十元。

本講座的目的是提供適當的學術環境，讓關心香港的人仕  
得以客觀地檢討香港的現狀和前途。形式將採取講課和討論會，  
內容則包括香港的歷史因素、地理條件、經濟結構、社會型態、  
政府組織、及公共策劃等。

歡迎各界人仕參加。

**211. Chinese Communities in America.** David Ip, B.Soc.Sc.(CUHK),  
M.A. (Hawaii), Assistant Lecturer in Sociology, University of Hong Kong,  
with guest lectures by C. K. Leung, M.A. (H.K.), David K. Tong, B.A.  
(Minnesota), M.A. (Hawaii), and C. T. Wu, B.Arch. (Calif.), M.S. (Col.).  
*Wednesdays, 8.00-9.30 p.m., starting February 21, 1973. Extra-Mural Town  
Centre. 10 meetings.* **Fee: \$55**

Overseas Chinese communities in Southeast Asia are often the cause of  
concern to local governments, while those in North America, particularly  
those in the United States, are dreamlands of prospective migrants. This  
course attempts a general survey, from the sociological viewpoint, of  
Chinese migration, Chinese immigrants, and Chinese communities  
including the stereotype and the myth of Chinatowns, their changing  
functions and problems, in North America. Examples will probably be  
drawn from Chinese communities in New York, San Francisco, Chicago,  
and Toronto. Lectures will be illustrated with slides wherever possible.

*See also :*

**164. A Review of the Prehistory of Hong Kong.** (Page 7)

**166. Current Hong Kong Housing Problems.** (Page 8)

**218. Marine Fishes of Hong Kong.** (Page 33)

**222. The Changing Role and Status of Women in China Through  
Literature.** (Page 35)

**223. Continuity and Change in Japanese Society.** (Page 36)

# Philosophy & Psychology

*Staff Tutor* : Miss N. P. Lee, *Telephone* 5-468161 *Ext.* 308

**212. Selected Topics in Child Development.** B. M. Young, B.Sc. (Edin.), Lecturer in Psychology, University of Hong Kong. *Wednesdays, 6.15-7.45 p.m., starting April 4, 1973. University Main Building. 10 meetings.* **Fee: \$60**

This course is mainly intended for those persons who, for personal or professional reasons, wish to learn how the emotions, attitudes and thought of the child develops and grows from infancy through to adolescence. No previous knowledge in this area is assumed.

Topics will include:

1. The development of intelligence in the pre-school child.
2. The infant: how intelligent is he really?
3. Identity problems in adolescents.
4. Socialisation: how cultures differ.
5. Child language: can we make sense of this?
6. The development of children's ideas of 'good' and 'bad'.

## **213. 初級現代邏輯 (Introductory Modern Logic)**

主 講 人：羅業宏先生。

講授語言：粵語。

地 點：香港大學校外課程部市區中心。

時 間：一九七三年二月十二日起，每星期一下午八時  
十五分至九時四十五分，共十講。

學 費：五十五元。

本課程以初學者為對象，介紹現代邏輯的基本知識及技術，目的在培養縝密嚴謹的思維習慣。課程內容如下：

- (一) 漢語中的邏輯連詞；
- (二) 以邏輯符號代替文字；
- (三) 語句的內容，蘊函關係，及結論之對錯；
- (四) 真值表及打孔卡；
- (五) 量語邏輯簡介。



**214. 自由之分析**  
**(An Analysis of Freedom)**

主 講 人：黃展驥先生。

講授語言：粵語。

地 點：香港大學校外課程部市區中心。

時 間：一九七三年二月二十七日起，每星期二下午八時至九時半，共八講。

學 費：四十五元。

自由問題向來是學術，政治，社會上聚訟紛紜的問題。本課程從邏輯謬誤角度評析一些名家（例如胡適、殷海光、張佛泉、海耶克等）的自由理論，內容包括：

- （一）自由的真意；
- （二）精神自由與外在自由；
- （三）自由與人權；
- （四）自由與必然；
- （五）國家自由與個人自由。

**215. An Introduction to Indian Thought.** Ian Watson, B.A. (Melb.), M.A. (McMaster), Lecturer in Philosophy, University of Hong Kong. *Wednesdays, 6.15-7.45 p.m., starting February 21, 1973. University Main Building. 8 meetings.* **Fee: \$45**

This course will offer an introduction to Indian Philosophy, through the thought of possibly its central formative influence—Hinduism. Hinduism is not just a philosophy, but also a philosophy in practice. Accordingly, this course will speak not only of this philosophy, but also try to illustrate its practice.

There is only one pre-condition for this course—a genuine interest in the tradition in question.

# Political Science

*Staff Tutor : C. K. Leung, Telephone 5-468161 Ext. 306*

**216. Introduction to International Politics.** G. G. Lawrie, B.A., LL.B., Senior Lecturer in Political Science, University of Hong Kong. *Wednesdays, 6.15-7.45 p.m., starting February 21, 1973. University Main Building. 10 meetings.* **Fee: \$60**

The purpose of the course is to introduce participants to the main concepts used in the modern study of international politics. It will not be a course in current affairs nor will it deal especially with South East Asia, although where possible South East Asian experience or problems will be used to exemplify more general ideas. Attention will be concentrated on the national states, the main actors in international politics, and on the means and methods by which they seek to achieve their ends. Ample opportunity will be given for discussion.

*Enrolment is limited to 25 persons.*

*See also :*

- 210. 香港的過去、現在和將來 (Hong Kong's Past, Present & Future).** (Page 29)
- 214. 自由之分析 (An Analysis of Freedom).** (Page 31)
- 222. The Changing Role and Status of Women in China Through Literature.** (Page 35)

## **PRIOR ENROLMENT IS ESSENTIAL**

Failure to enrol prior to the opening of a particular course may mean the cancellation of that course. Prior enrolment is the only way the Department of Extra-Mural Studies has of judging the response to its courses. Your co-operation is therefore invited in sending your application forms to the Department as soon as possible.

# Science & Mathematics

*Staff Tutor* : Mrs. Priscilla Tso, *Telephone* 5-468161 *Ext.* 303

## 217. 恆星天文學概論 (An Outline of Stellar Astronomy)

主 講 人：廖慶齊先生。  
講授語言：粵語。  
地 點：香港大學校外課程部市區中心。  
時 間：一九七三年三月三十日起，每星期五下午七時  
至八時三十分。  
學 費：五十五元。

本課程用通俗方式闡述恆星天文學之基本概念與方法，全部十二講，內容包括：

- 恆星天文學之研究對象及意義。
- 恆星之物理性質。
- 恆星之距離，運動與空間分佈。
- 星團，星協，星族。
- 星際物質。
- 銀河系之結構。
- 河外星系及總星系等。

## 218. 香港海洋魚類 (Marine Fishes of Hong Kong)

主 講 人：香港政府漁業研究所主任陳禮宜碩士。  
講授語言：粵語。  
地 點：香港大學校本部。  
時 間：一九七三年二月十六日起，每星期五下午六時  
十五分至七時十五分。  
學 費：卅五元。

本課程共十講，旨在介紹香港海鮮魚類，包括魚類之形態，分類、生態、習性，分佈及漁業各方面之問頭。內容適應生物學教師，學生及一般對生物學有認識或對魚類有興趣人士修讀，並以魚類標本及幻燈片示範。課程期內另舉行一次標本採集活動。

**219. Secondary School Mathematics for Teachers.** Ho Siu Lun, B.Sc. (Lond.), A.F.I.M.A., and Tsui See Ming, B.A., Dip.Ed. (H.K.). *Fridays, 6.15-7.45 p.m., starting February 16, 1973. University Main Building. 12 meetings.* **Fee: \$60**

This course is designed as a refresher course for teachers teaching Modern Mathematics in secondary schools. It will be particularly useful for teachers of Forms 3, 4 and 5. The aim is to provide teachers with more teaching material for classroom use. Mathematical topics as well as other background material will be discussed.

**220. Certificate Course in Medical Laboratory Technology** (ordinary level).

A two-year Certificate Course in Medical Laboratory Technology designed to provide a broad based science education in biochemistry, biology, mathematics and medical laboratory science for technicians-in-training *already working* in medical laboratories.

The course will commence in February and will take place on two or three evenings a week at the University of Hong Kong.

Trainee technicians already working in medical laboratories, or their employers, are invited to apply for further particulars to the Director of Extra-Mural Studies, University of Hong Kong.

*See also :*

**185. Topics in Sixth Form Chemistry.** (Page 18)

# Social Work & Sociology

*Staff Tutor* : Miss N. P. Lee, *Telephone* 5-468161 *Ext.* 308

## 221. 社會工作督導 (Supervision in Social Work)

主 講 人：李希旻女士，羅惠潔女士，黃若蓮女士，楊黃佩霞女士，吳夢珍女士。

講授語言：粵語（輔以英語）。

地 點：香港大會堂九樓北演講廳。

時 間：一九七三年二月十四日起，每星期三下午六時至七時三十分。

學 費：八十元。

本課程共十二講，主要為在福利機構負責督導社會工作人員或學生之人員而設，內容包括對社會工作督導作全面性的探討，如個案工作，小團及社區工作，學生訓練等，研討執行督導所具備的工作原則，要點，及一般常見實際問題，授課方式包括研討，角色扮演個案分析等。

## 222. *The Changing Role and Status of Women in China Through Literature.* Miss Shelley Wong, B.A. (Calif.). *Wednesdays, 7.00-8.30 p.m., starting February 14, 1973. Hong Kong Christian Council, Metropole Building, 5th floor, 57 Peking Road, Kowloon. 12 meetings.* **Fee: \$60**

This course will compare depictions of women in literature from three different periods: Ancient, Republican, and Communist China. Discussion will include such topics as: Changes in the family system and women's role and status, the rise and development of the women's movement, and Communist policies toward women today.

Works selected will include excerpts from: *Book of Poetry*, *Dream of the Red Chamber*, *Selected Stories of Lu Hsun*, Pa Chin's *The Family*, Han Suyin's autobiographical trilogy, Madame Sun's selected works, the current model plays such as *The Red Lantern*, and short stories from China today. Reference will be made to the tutor's observations during her recent tour of China of the current role and status of women.

**223. Continuity and Change in Japanese Society.** Mrs. Stephenie Levin, B.A. (Ohio), M.A. (Ill.). *Thursdays, 6.15-7.45 p.m., starting February 15, 1973. University Main Building. 10 meetings.* **Fee: \$60**

In this course, the idea will be developed that pre-industrial social institutions are not necessarily incompatible with the requirements of industrialising societies. This idea will be illustrated with particular reference to the Japanese family and kinship system, showing how this system provided employers with a mobile and highly motivated work force and how the ideal model of the family system was utilised by employers as a basis for organising behaviour in industrial organisations.

*See also :*

**166. Current Hong Kong Housing Problems.** (Page 8)

**201. Introduction to Urban Geography.** (Page 24)

**211. Chinese Communities in America.** (Page 29)

### **PRIOR ENROLMENT IS ESSENTIAL**

Failure to enrol prior to the opening of a particular course, may mean the cancellation of that course. Prior enrolment is the only way the Department of Extra-Mural Studies has of judging the response to its courses. Your cooperation is therefore invited in sending your application forms to the Department as soon as possible.

### **預早報名之重要**

及早報名乃是使本部得知各界對種種課程反應之唯一途徑，如不及早報名則往往引致各該課程延期或取消。故有志修讀本部課程者，敬希從速將報名申請書寄回本部。

### **University of Hong Kong Department of Extra-Mural Studies**

### **香港大學校外課程部**

The whole of this form together with the appropriate fee should be sent to  
THE DIRECTOR OF EXTRA MURAL STUDIES  
THE UNIVERSITY OF HONG KONG.

申請書填妥後附學費交香港大學校外課程部主任

Payment may be made in cash or by cheque at the University or by post. Cheques should be crossed and made payable to "University of Hong Kong".

繳費可用支票或現金，如用支票請以「香港大學」名義抬頭，並加橫線，逕寄本部。

*The issue of an Enrolment Application Acknowledgement does not of itself constitute acceptance of the application, but if you do not hear otherwise before a course starts, you may assume you have been accepted, if for any reason you are not accepted your fee will be returned, but otherwise fees are not normally refundable.*

除非課程臨時取消或改期，請依照公佈日期上課，本部不另通知。如報名申請未被接受，學費將退還；但課程開始後，學費通常不能退還。



# UNIVERSITY OF HONG KONG 香港大學 EXTRA MURAL STUDIES 校外課程

## APPLICATION FOR ENROLMENT 報名申請書

Please use a separate form for each course 每一申請書只適用於一種課程

Course No. 課程號碼 \_\_\_\_\_ Course name 課程名稱 \_\_\_\_\_  
Fee enclosed 附學費 \$ \_\_\_\_\_ Cash/Cheque No. 現金/支票號碼 \_\_\_\_\_

Name in full 姓名 (Mr./Mrs./Miss) English 英文 \_\_\_\_\_  
(in block letters—surname first) Chinese 中文 \_\_\_\_\_

What Extra Mural Courses have you previously attended? 曾修讀之其他校外課程

\_\_\_\_\_

Name in full 姓名 (Mr./Mrs./Miss) English 英文 \_\_\_\_\_  
(in block letters—surname first) Chinese 中文 \_\_\_\_\_

Correspondence address 通訊處 \_\_\_\_\_

Office address 辦事處地址 \_\_\_\_\_

Telephone Nos. 電話 Home 住宅 \_\_\_\_\_ Office 辦事處 \_\_\_\_\_

Nationality 國籍 \_\_\_\_\_ Age (please tick age group): 18-19  40-49   
Occupation 職業 \_\_\_\_\_ 年齡 (請加✓於適當方格內) 20-29  50-59   
30-39  over 60

Education (please tick) 教育程度 (請加✓於適當方格內)

- Primary 小學  College of Education 師範  
 Secondary 中學  University 大學  
 Technical College 工專  Post graduate 研究院

Others 其他 \_\_\_\_\_

Degree or professional qualification held 大學學位或專業資格 \_\_\_\_\_

Date 日期 \_\_\_\_\_ Signature 簽字 \_\_\_\_\_

For Office Use 不必填寫 \_\_\_\_\_ X

Date 日期 \_\_\_\_\_ Reg. No. 註冊號碼 \_\_\_\_\_ Course No. 課程號碼 \_\_\_\_\_ Amount 金額 \_\_\_\_\_

For Office Use 不必填寫 \_\_\_\_\_ X

Date 日期 \_\_\_\_\_ Reg. No. 註冊號碼 \_\_\_\_\_ Course No. 課程號碼 \_\_\_\_\_ Amount 金額 \_\_\_\_\_

Please complete this part if you require an acknowledgment of your application.

Note: This application acknowledgment is not complete without validation by official printing machine entry of the details at X above at the University or Town Centre office of the Department of Extra-Mural Studies, University of Hong Kong.

如欲本部寄奉報名繳費收條，請填妥本欄。

注意：本收條未經本部或本部市區中心辦事處收銀機在 X 欄內印出金額、日期等，即未生效。

Name 姓名  
Full postal  
Address 地址

Fees are not refundable once the course has commenced 課程開始後學費不能退還。 Please see overleaf 請看背面。



# GROUND PLAN OF UNIVERSITY OF HONG KONG MAIN BUILDING

showing location of rooms used for extra mural courses. Please see inside of front cover for University general layout.

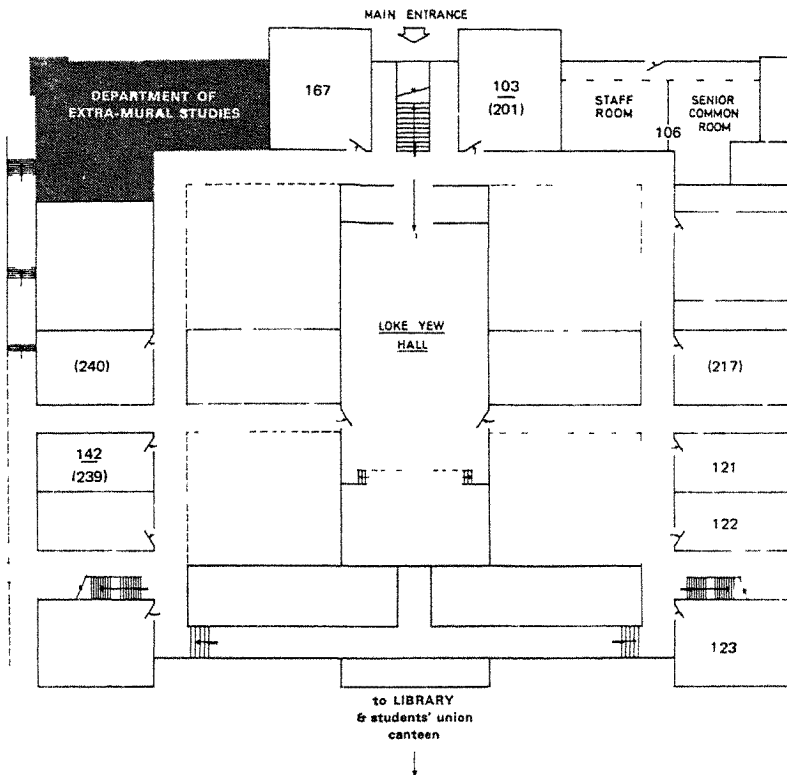

**LIBRA PRESS LTD.**

**56 Wong Chuk Hang Road, Hong Kong**



X45590684

香港大學校外課程手冊

一九七三年春季

SPRING PROSPECTUS  
1973



**Extra Mural Studies**

**University of Hong Kong**