

Extra Mural Studies
University of Hong Kong

一九六九至一九七零

香港大學校外課程手冊



HKS
374
U5

Spring Supplement 1970

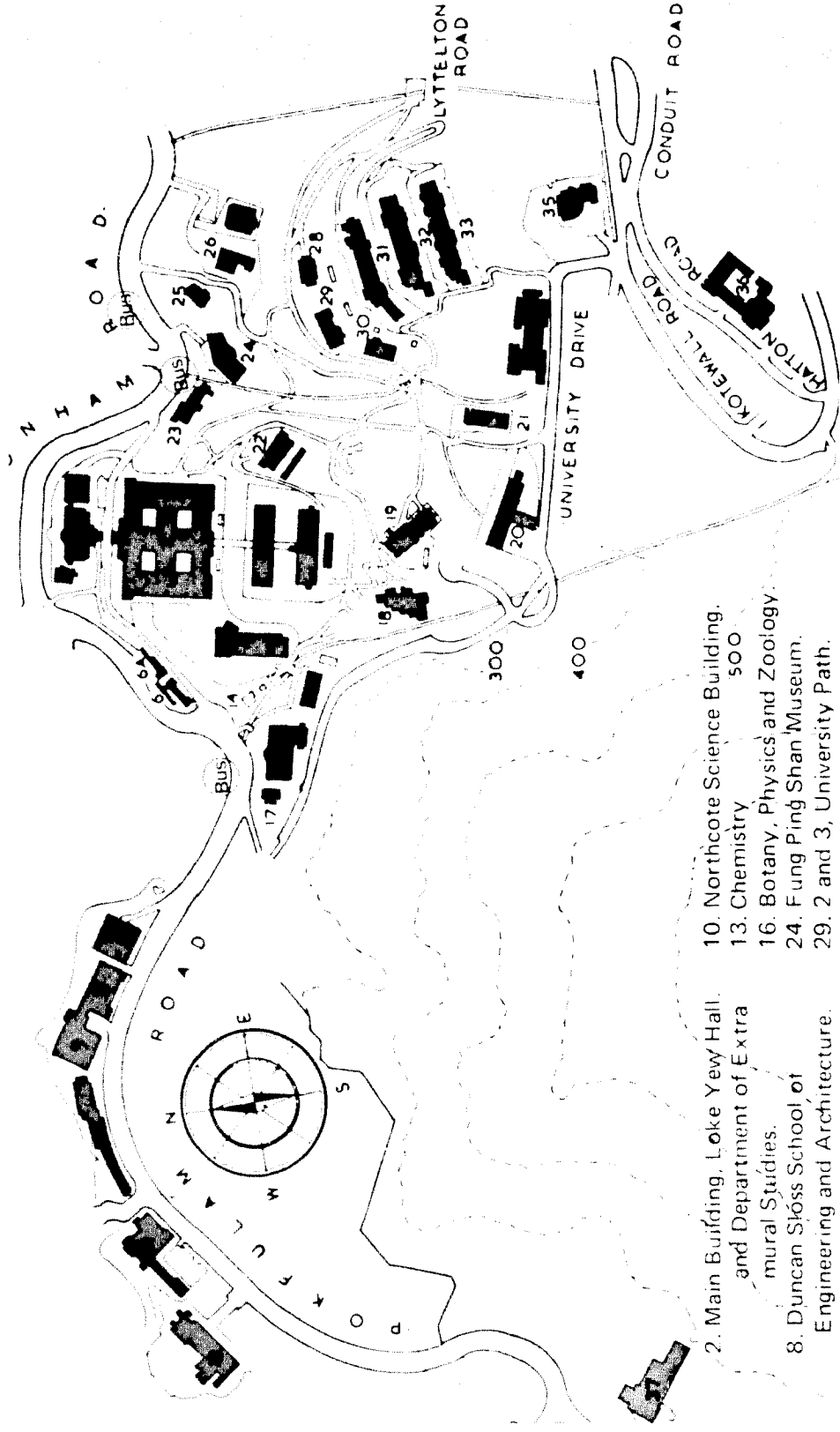

- 2. Main Building, Loke Yew Hall, and Department of Extra mural Studies.
- 8. Duncan Sloss School of Engineering and Architecture.
- 9. Peel Laboratory.
- 10. Northcote Science Building.
- 13. Chemistry 500
- 16. Botany, Physics and Zoology.
- 24. Fung Ping Shan Museum.
- 29. 2 and 3, University Path.

UNIVERSITY OF HONG KONG GENERAL LAYOUT

Please see inside of rear cover for enlarged plan of Main Building (2) and room locations

University of Hong Kong



Extra Mural Studies



STAFF

Director

R.A. Williams, M.A.(Wales)

Deputy Director

J.W. England, B.A.(Nottingham)

Assistant to the Director

Mrs. Priscilla Tso, B.A., Dip.Ed.(H.K.),
Dip.Ad.Ed.(Manchester)

Staff Tutors

Mrs. Nana Tsao, B.A., Dip.Ed.(H.K.)

C.K. Leung, M.A.(H.K.) on leave

Jon A. Prescott, B.Arch., M.C.D.(Liv.),
A.R.I.B.A., A.M.T.P.I.

D.J.H. Macintosh, M.A.(Cantab.)

Assistant Staff Tutor

Edward K.Y. Chen, B.A.(H.K.)

Secretary

Mrs. Yvonne Wong

ACKNOWLEDGEMENTS

We would like to record our grateful acknowledgement to the following individuals, schools and organizations for permission to use their premises:

Design + Research Co-ordinators Limited
Education Department, Government of Hong Kong
The Government Printer
King's College
The Management of the City Hall
Resettlement Department, Government of
Hong Kong
University Hall

GENERAL INFORMATION

1. There are normally no entry requirements except that applicants should be over 18 years of age. Occasionally to have the full benefit of a course applicants must possess certain defined qualifications. Applicants are therefore advised to read the description of a course carefully. Professional courses usually have clearly defined entry requirements.
2. The Director may at his discretion refuse to admit an applicant.
3. Unless otherwise arranged no Extra Mural lectures will be held:
 - a) on any public holidays,
 - b) at a storm warning signal of No.5 or above,
 - c) during the following holiday period: 4–10 February, 1970 (Chinese New Year).
4. The course fee will cover the entire duration of a course or part of a course. Fees are not refundable once the course has commenced.
5. Certificates of Attendance are issued on payment of 50 cents, to those who have attended not less than two thirds of a course of at least 20 meetings duration
6. Closing date for enrolment: One week before the commencement date of a course. Late enrolments may not be accepted.
7. For enquiries, please ring either H-468161 Ext.309 or H-226529 during office hours.

HOW TO ENROL

1. Complete the attached enrolment form and mail it to the Director, Department of Extra Mural Studies, University of Hong Kong. Forms are also available on request.
2. To ensure that a class can take place, the Department would appreciate early enrolment by applicants.
2. You should send your application form together with the appropriate fee either in the form of a postal order or crossed cheque made out in favour of the "University of Hong Kong"
3. You will be notified if you are not admitted because of over-subscription or other reasons. The Department will NOT notify successful applicants who are expected to attend the first meeting of the class at the place and time advertised.
4. Applicants can also enrol in person at the following places:
 - (i) Department of Extra Mural Studies, University of Hong Kong, University Main Building, Ground Floor, Pokfulam Road, (during office hours).
 - (ii) Extra Mural Town Centre, Universal House, 11th Floor, 151 Des Voeux Road Central, entrance from Gilman Street (next to Tamaya Department Store).
Tel. No. H-226529 (from 9 a.m. to 8.00 p.m.).

入學須知

1. 學員申請資格，除特別規定學歷之課程外，其他課程，祇需要年齡超過十八歲者，不限資格，均可申請入學。學員應詳閱課程簡介。
2. 學員被取錄與否概由校外課程部主任審核報名申請書後決定之。
3. 除特殊情形外，本部在下列期間不授課：
甲、本港公眾假期。
乙、本港天文臺懸掛五號或以上風球之後。
丙、農曆新年假期：一九七〇年二月四日至十日。
4. 本手冊內之學費係指課程之全期學費。課程開始後，學費通常不能退回。
5. 授課時間通常每講一小時。
6. 凡課程在廿講以上而學員上課次數超過三分之二者，得向本部繳費五角後申請發給聽講證書。
7. 學員應於開課一星期前報名，過期報名可能不被接受。又任何課程額滿後，即隨時截止報名，故學員應儘早報名。
8. 本部詢問電話 H-468161（內線 309）或 H-226529。

報名手續

1. 填妥附於本手冊之報名申請書後，逕寄香港大學校外課程部主任收。申請書可隨時向本部索取。
2. 繳費可用支票，銀行本票，或郵政滙票，抬頭「香港大學」隨同申請書逕寄港大校外課程部主任收。如用現金則請至本部繳納。
3. 如申請人已獲取錄，本部不再通知，可依時上課。如未獲取錄，則另函通知。
4. 申請人亦可親往下列地點報名：
甲、薄扶林道香港大學校外課程部（辦公時間內）電話：H-468161（內線 309）。
乙、香港德輔道中一百五十一號環球大廈十二樓（入口在機利文街，玉屋百貨公司右側）校外課程部市區中心。
電話：H-226529

Contents



ARCHAEOLOGY	7
ARCHITECTURE	8
Background to Japan	
ART & DESIGN	11
Certificate Course in Art & Design	
Foundation Courses	
Complementary Courses, History & Appreciation	
Vocational: Advertising & Interior Design	
Fine Art	
CHINESE STUDIES	18
ECONOMICS, COMMERCE, MANAGEMENT	20
EDUCATION	24
ENGLISH STUDIES	26
GEOLOGY & GEOGRAPHY	29
HISTORY	30
LANGUAGES	31
Oriental	
European	
LAW	33
MATHEMATICS	34
PHILOSOPHY, PSYCHOLOGY & SOCIOLOGY	36
SCIENCE	40

PRIOR ENROLMENT IS ESSENTIAL

Failure to enrol prior to the opening of a particular course, may, mean the cancellation of that course. Prior enrolment is the only way the Department of Extra-Mural Studies has of judging the response to its courses. Your co-operation is therefore invited in sending your application forms to the Department as soon as possible.

Archaeology

Staff Tutor in Charge: Jon A. Prescott, B.Arch., M.C.D.(Liv.), A.R.I.B.A., A.M.T.P.I.
Telephone No. H-226613

77 AN INTRODUCTION TO THE ART OF BRONZE AGE CHINA Fee: \$35 177

James C.Y. Watt, B.A.(Oxon.)

Assistant Curator, City Art Gallery & Museum

*4 meetings, Mondays 8.00–9.30 p.m., beginning 23 February, 1970,
Extra Mural Town Centre*

This course was postponed from last term to allow the incorporation of recently acquired additional material. It will provide an introduction to the bronze art of Shang and Chou china with special reference to the historical background and the social organization of the times.

The lecture will be illustrated by many specially prepared slides

Architecture

Staff Tutor in Charge: Jon A. Prescott, B. Arch., M.C.D.(Liv.), A.R.I.B.A., A.M.T.P.I
Telephone No. 226613

BACKGROUND TO JAPAN

A Study in connection with Man Made Environment, Arts & Architecture.

This series of courses has been arranged to coincide with the Osaka International Exposition 'Expo 70' which opens on the 15 March, 1970 and is the first world exposition to be held in Asia.

The Study will concern itself with the man made environment and Arts and Architecture of Japan in the context of an emergent industrialized nation having powerful traditional ties, and will cover both some traditional elements and modern aspects of Japanese culture.

Lecture courses already held have covered basic studies of the historical outline up to the turn of the century including archaeology and a limited discussion of geographical features.

THE NEW JAPAN 1. NATIONAL REGIONAL & CITY PLANNING 2. HOUSING

Uno Winblad, Arch.C.T.H.(Goth.), Dip.Trop.(A.A.Lond.), S.A.R.

2 public meetings, Thursday and Friday, 6.00—7.00 p.m., 8 and 9 January, 1970, Extra Mural Town Centre

The rapid growth of the Japanese economy in the nineteen fifties and sixties has brought about drastic changes in the spatial distribution of population and activities. The initial lecture will outline the steps taken to resolve the problems resulting from these changes: The comprehensive National Land Development Plan of 1969, the 1968 "civil minimum" plan for Tokyo and the City Planning Law which came into effect in 1969.

The second lecture will be devoted to Housing. Japan produces annually more than a million dwelling units. An outline will be given of present housing policies together with a description and evaluation of the different kinds of Government Aided Housing.

19 BACKGROUND TO JAPAN I Fee: \$45 19
JAPANESE TRADITIONAL DESIGN

Jon A. Prescott, General Co-Ordinator, Martin Bradley, David W. Crowe, Dip.Arch., A.R.I.B.A., Allan Schiller, B.F.A.

5 meetings, Thursdays 7.00–9.00 p.m., beginning 12 February, 1970, Extra Mural Town Centre

These lectures will give some basic philosophical background to the traditional Arts and Architecture of Japan and will explain the importance of Shinto and Zen Buddhism to architecture, garden layout and painting. Various media will be considered, including the craft of the potter, of great importance in Japan and wood block printing, probably the best known means of Japanese visual expression.

On the evenings when supplementary films are shown the meeting will be extended to 10.00 p.m.

178 BACKGROUND TO JAPAN II THE NEW JAPAN Fee: \$45 178

Jon A. Prescott, General Co-Ordinator, N.R. Bennett, B.Sc.(Econ.), Ph.D. (Lond.) and Martin Bradley

5 meetings, Fridays 7.00–9.00 p.m., beginning 13 February, 1970, Extra Mural Town Centre

The historical outline included in this series has been designed to cover the emergence of the modern nation of Japan in the years 1900–1970. Consideration will be given to the economic and organization structure and its links with political change. The expression of these changes in urban planning and in an Architecture which is of world significance will be discussed and contemporary manifestations in traditional and new art forms considered.

On the evenings when supplementary films are shown the meeting will be extended to 10.00 p.m.

Background to Japan I & II are offered together at a combined fee of \$80.

PRIOR ENROLMENT IS ESSENTIAL

Failure to enrol prior to the opening of a particular course, may, mean the cancellation of that course. Prior enrolment is the only way the Department of Extra-Mural Studies has of judging the response to its courses. Your co-operation is therefore invited in sending your application forms to the Department as soon as possible.

Art and Design

Staff Tutor in Charge Jon A Prescott, B Arch (Liv), MCD, ARIBA, AMPTI
Telephone No H-226613

Certificate Courses in Art and Design

The Certificate Courses in Art & Design will be open for new applicants in the Autumn Term 1970.

The instruction is of three years duration, the first year being considered a Foundation Year with the vocational elements restricted to the two final years. The general object is to provide a broad background study and not to foster a narrow specialization in terms of Design

Although courses are developed in an integrated pattern primarily for the Certificate Student many are complete in themselves and all of the following courses have openings for the general student in Spring 1970.

PRESCRIBED COURSES FOR CERTIFICATE STUDENTS

Year I Term II (Foundation)

- | | | |
|---|------|------------------------|
| 1. History of Art I Introductory Course | (29) | Cesar A. Guillen-Nunez |
| 2. Relationships of Colour | (21) | Tao Ho |
| 3. Techniques of Draughtsmanship | (22) | Ruth H. Addison |
| 4. Life Drawing I | (25) | Michael F. Griffith |
| 5. Painting Studio I | (24) | Marcia Tanner |
| 6. Introduction to Three Dimensional Design | (26) | Paul Selinger |

Year II Term IV

- | | | |
|-------------------------------|------|------------------------|
| 1. Grammar of Visual Form C/D | (42) | Jon A. Prescott |
| 2. History of Art II | (39) | Cesar A. Guillen-Nunez |
| 3. Life Drawing II | (30) | Tomas Almberg |

Fine Art

- | | | |
|-----------------------------|------|------------------|
| 4. Painting Studio | (32) | Y.T. Kwong |
| 5. Three Dimensional Design | (33) | Cheung Yee |
| 6. Painting Inquiry | (36) | Wucius C.K. Wong |

Advertising Design

- | | | |
|---|------|---------------|
| 4. Advertising Studio II | (50) | Leslie Harper |
| 5. Printing Technology | (52) | R.K. Cheng |
| 6. Basic Photographic Techniques & Illustration | (54) | Laurence Ng |

Interior Design

- | | | |
|--|------|-----------------|
| 4. Interior Studio II | (44) | Ruth H. Addison |
| 5. Nature of Materials & Detailing | (46) | Ruth H. Addison |
| 6. Technical Services | (47) | R.A. Callow |
| 7. Three Dimensional Design (optional) | (33) | Paul Selinger |

Year III Term VI

Fine Art

- | | | |
|---------------------------------------|------|--|
| 1. History of Art III (Special) | (40) | Cesar A. Guillen-Nunez
Individual Tutor |
| 2. Special Study | | |
| 3. Life Drawing & Modelling from Life | (31) | Tomas Almberg |
| 4. Fine Art Studio | (37) | Chung Yee |
| 5. Three Dimensional Design | (33) | Paul Selinger |
| 6. Painting Inquiry | (36) | Wucius C.K. Wong |

Advertising Design

- | | | |
|--|------|------------------------|
| 1. Special Study | | Individual Tutor |
| 2. Advertising Studio III | (51) | Henry Steiner |
| 3. Processes of Production | (56) | Patrick Printer |
| 4. Photographic Techniques II | (55) | Laurence Ng |
| 5. History of Art II | (39) | Cesar A. Guillen-Nunez |
| 6. Professional Practice in Advertising & Design | (53) | |
| 7. Life Drawing III & Modelling from Life (optional) | (31) | Tomas Almberg |

Interior Design

- | | | |
|--|------|--|
| 1. History of Art III (Special) | (40) | Cesar A. Guillen-Nunez
Individual Tutor |
| 2. Special Study | | |
| 3. Interior Studio III | (45) | Terence Byrnes |
| 4. Nature of Materials & Detailing II | (49) | John Burfield |
| 5. Technical Services | (47) | R.A. Callow |
| 6. Professional Practice in Interior Work | (48) | A.A. Bunting |
| 7. Life Drawing III & Modelling from Life (optional) | (31) | Tomas Almberg |

Prescribed Courses

Reference should be made to the main Prospectus issued in Autumn, 1969 for details of courses which are not listed in this Spring Supplement.

- 21 THE RELATIONSHIP OF COLOUR** Fee: \$90 21
 Tao Ho, B.A.(Williams), B.Arch.(Harvard)
 15 meetings, Mondays 6.00–7.00 p.m., critique 7.00–8.00 p.m., beginning 5 January, 1970, Extra Mural Town Centre
- A complementary series of lectures and critiques to follow up the discussions on Form and Texture. Consideration will be given to theories of colour and the organization of colour (Munsell, Oswald, etc.) and basic phenomenon such as contrast, harmony, discord, transparency will be developed by the student in a series of exercises which will be set each week. No studio work will take place during the session which will be devoted to the critique and explanation.

Complementary Courses History & Appreciation

- 29 HISTORY OF ART I INTRODUCTORY COURSE** Fee: \$90 29
 Cesar A. Guillen-Nunez, B.A.(Courtauld Institute of Art, London)
 15 meetings, Mondays 8.00–9.00 p.m., tutorial 9.00–10.00 p.m., beginning 5 January, 1970, Extra Mural Town Centre
- A general framework of the History of Art will be introduced following some discussion of historical method. The course is intended as a background one in preparation for a further examination of the more recent period which is covered in History of Art II.
- 42 GRAMMAR OF VISUAL FORM** Fee: \$90 42
 Jon A. Prescott, B.Arch., M.C.D.(Liv.), A.R.I.B.A., A.M.T.P.I.
 15 meetings, Tuesdays 8.00–9.00 p.m., tutorial 9.00–10.00 p.m., beginning 6 January, 1970, Extra Mural Town Centre
- The aim of a 'Grammar of Visual Form' is to provide a training in visual understanding. The course consists of four sections and is based on the studies of Kurt Rowland whose text* is used as a reference. Parts A & B "Pattern & Shape" and "The Development of Shape" will be offered in the 1970-71 session. Parts C & D "The Shapes We Need" and "The Shape of Towns" are offered in the current session.
- | | |
|---|--|
| <p>C. "The Shapes We Need"
 The man made world is a synthesis of two approaches to design, the rational, scientific and analytical aspect and the intuitive 'inspired' human influence. Discussion will centre on how these elements are combined and what principles are involved.</p> | <p>D. "The Shape of Towns"
 The Town is one of the most complex man made set of shapes which exists. Its study brings out the variety and vast scale of design problems. Though we may look at it chiefly as a means of organizing the problems of urban living, Town Design is an art form.</p> |
|---|--|
- * "Looking and Seeing", Vols.1–4, Kurt Rowlands, M.S.I.A., Ginn & Co. Ltd., 1963. Copies will be available for purchase by students

VOCATIONAL: Advertising & Interior Design

53 PROFESSIONAL PRACTICE IN ADVERTISING & DESIGN Fee: \$60 53

12 meetings, Tuesdays 8.00–9.00 p.m., beginning 20 January, 1970, Extra Mural Town Centre

A course covering professional attitudes, arrangement of contracts, the relationship of various parties in the letting of work. The basis of costing obtaining tenders and various other relevant procedural methods will be analyzed and discussed.

48 PROFESSIONAL PRACTICE IN INTERIOR WORK Fee: \$60 48

A.A. Bunting, F.R.I.C.S., D.P.A.(Glas.), A.S.V.A.

12 meetings, Tuesdays 8.00–9.00 p.m., beginning 20 January, 1970, Extra Mural Town Centre

A course covering professional attitudes, arrangement of contracts, the relationship of various parties in contracting work, both under present Hong Kong practice and under other conditions. Methods of cost analysis of work, tendering procedure and practical procedural methods will be compared and discussed.

Fine Art

30 LIFE DRAWING II Fee: \$90 30

Tomas Almberg, Swedish National Diploma (Stockholm)

15 studio meetings, Mondays 8.00–10.00 p.m., beginning 5 January, 1970 Extra Mural Town Centre

A life class for students who have achieved an intermediate level of competence. On most evenings a model will be used, for which there will be an additional charge of \$25 for the term, payable in advance.

The use of various media will be encouraged and the individual development of the student considered a primary aim.

Enrolment will be limited to 25 persons.

- 31 LIFE DRAWING & MODELLING FROM LIFE** **Fee: \$100 31**
 Tomas Almborg, Swedish National Diploma (Stockholm)
15 studio meetings, Fridays 8.00–10.00 p.m., beginning 9 January, 1970, Extra Mural Town Centre
 A more advanced class in which studies will be made in two and three dimensions from a live model. There will be an additional charge of \$25 for the term payable in advance.
 Modelling stands and materials will be available within the course fee. Students should have previous experience of life drawing.
 Enrolment will be limited to 25 persons.
- 32 PAINTING STUDIO II** **Fee: \$90 32**
 Y.T. Kwong, M.Sc.(Kansas)
15 studio meetings, Tuesdays 6.00–8.00 p.m., beginning 6 January, 1970, Extra Mural Town Centre
 An intermediate level class for continued painting experience. The aim is to allow individual students to develop at their own pace under expert guidance.
 Non-certificate students who have taken Part I Painting or who have some experience already will be welcome.
 Enrolment will be limited to 25 persons.
- 36 PAINTING INQUIRY—** **Fee: \$90 36**
A CONTINUING SEMINAR & STUDIO
 Wucius C.K. Wong, M.F.A.(Maryland) and Guest Tutors
15 studio meetings, Mondays 6.00–8.00 p.m., beginning 5 January, 1970, Extra Mural Town Centre
 This continuing seminar will consist of organized discussion combined with studio practice, the whole emphasis being on the discussion of expression of ideas, methods of work and approach to conceptually creative thinking.
 Under the general direction of Mr. C.K. Wong various well known Hong Kong Artists will participate from time to time.
 There will be a limited enrolment of 20 persons who should be either registered certificate students or have considerable painting experience to their credit.

37 FINE ART STUDIO Fee: \$90 37

Cheung Yee

15 studio meetings, Fridays 6.00–8.00 p.m., beginning 9 January, 1970, Extra Mural Town Centre

More advanced studio facilities to enable students to develop under professional tuition. Individual development will be encouraged and print making and relief work introduced to extend the students painting experience.

Enrolment will be limited to 20 persons who should be either registered certificate students or have considerable experience to their credit.

33 THREE DIMENSIONAL DESIGN Fee: \$90 33

Cheung Yee

15 studio meetings, Wednesdays 6.00–8.00 p.m., beginning 7 January, 1970, University Hall, Pokfulam

A series of studio meetings enabling exploration of the problems of three dimensional composition and sculpture. Students will work on practical problems in various media and should be prepared to devote additional time to that involved in formal tuition. The studio will remain open until 10.00 p.m. and can be made available by arrangement.

34 SECOND TERM PAINTING & DRAWING Fee: \$90 34

Peter Lam

15 studio meetings, Saturdays 9.30–11.30 a.m., beginning 17 January, 1970, Extra Mural Town Centre

The second term of an introductory course in painting and drawing. The tutor will introduce various subjects, techniques and media, analysing historical and present day examples of relevance to the techniques introduced.

The Studio will be available until 1.00 p.m., but instruction will be limited to the initial two hours.

Enrolment will be limited to 25 persons.

35 SECOND TERM PAINTING & DRAWING Fee: \$90 35

Peter Lam

15 studio meetings, Thursdays 6.00–8.00 p.m., beginning 22 January, 1970, King's College, Bonham Road, Hong Kong

As Course No.34 but arranged for the evening.

Enrolment will be limited to 25 persons.

Rosamond Brown

12 studio meetings, Thursdays 9.30–11.30 a.m., beginning 19 February, 1970, Extra Mural Town Centre

All who know the work of Mrs. Brown will appreciate that her approach to water based media is bold, strong and a complete denial of the somewhat lasting impressions that last century painters have left with us that water colour is in itself a limiting media capable only of expression through brushes of two or three hairs.

This course will offer instruction in the use of water colour, acrylics (used "in a water colour way"), crayon with water, inks and dyes, and the tutor will encourage expression on a bold scale in line with her own approach. The Studio will be available from 9.30 a.m. until 1.00 p.m. although instruction will only be given in the initial two hours.

Students will provide their own materials. Enrolment will be limited to 25 persons.

202 PAINTING STUDIO

Fee: \$80 202

Stephanie Mathews

10 studio meetings, Tuesdays 2.30–4.30 p.m., beginning 17 February, 1970, Extra Mural Town Centre

A small class in oil painting for beginners as well as more advanced students. Individual attention will be given and students encouraged to develop their own sense of experiment.

Mrs. Mathews is a well known local critic who has considerable teaching experience and was trained at the Art Student League of New York and the University of California, Berkley.

Students will provide their own materials, but there is a small shop on the premises which will be open before each session commences.

Enrolment will be limited to 15 students.

See also under Education page 24 and 25

214 The Teaching of Art in Primary school

215 The Teaching of Art in Secondary school

Chinese Studies

Staff Tutor in Charge: Nana Tsao, B.A., Dip.Ed (H.K.) Telephone No. H-468161 Ext. 306

58 THEORY & PRACTICE OF CHINESE CALLIGRAPHY Fee: \$120

H.H. Fung

14 meetings, Wednesdays 7.00–9.00 p.m., beginning 18 February, 1970,
Extra Mural Town Centre

書 法 源 流

本課程共十四講，每週一次，每次二小時，專為愛好研究中國書法者而設，理倫與實習並重，主要講題如下：

- (一) 書法與文字之關係
- (二) 書法演變
- (三) 篆隸行楷之書法介紹
- (四) 執筆、運筆、結體
- (五) 各體書法示範

主 講 人：馮康侯先生

講授語言：粵語

時 間：一九七〇年二月十八日起每星期三下午七時至九時

地點 點：香港大學校外課程部市區中心

學 費：一百廿元（限收十四名）

66 CHINA IN THE LAST CENTURY Fee: \$55

K. Lai

12 meetings, Fridays 7.00–8.30 p.m., beginning 20 February, 1970,
Committee Room North, City Hall, Hong Kong

中國近百年史

本課程分十次講，由道光年間中英戰爭起講，中述太平天國，洋務運動，中法之役，甲午之役，戊戌政變，拳民之亂，辛亥革命，民國成立，軍閥割據，以至國民政府統一中國為止，其間政治演變之因果，西方文化之輸入，社會風俗之趨向，皆詳加說明，使明瞭中國近百年以來之大勢。

主 講 人：黎傑先生

講授語言：粵語

地 點：香港大會堂八樓北會議室

時 間：一九七〇年二月廿日起每星期五下午七時至八時三十分

學 費：五十五元

M. Topley, Ph.D.(Lond.)

12 meetings, Tuesdays 6.15–7.15 p.m., beginning 17 February, 1970, Building 17, Room B, University of Hong Kong

This series of lectures is designed for those who wish to learn something of the role of Chinese customs and traditional ways of thought in Hong Kong life today. It will discuss also changes in some of the traditional patterns of thought and behaviour. Topics to be included are Chinese family and marriage; child-rearing and the position of women; Chinese names; clan and ancestor worship; geomancy; Chinese traditional medicine; religion; and popular festivals.

M. Topley, Ph.D.(Lond.)

8 meetings, Wednesdays 6.15–7.15 p.m., beginning 11 February, 1970, Committee Room North, City Hall, Hong Kong

The focus will be on religion and its role in the life of ordinary people in Hong Kong today—rural and urban. Discussion will centre around the “situational” significance of religion: the traditional role of religion in accordance with different social requirements, e.g. in the family, in such occupations as farming, crafts and trades. In this context the emergence of different cults and sects, and the role of the priesthood in popular religious practices, and their formal organization will also be touched upon. Enrolment will be limited to 25 persons.

Economics Commerce Management

Staff Tutor in Charge: Edward K.Y. Chen, B.A (H.K.) Telephone No. H-468161 Ext. 309

205 MANAGERIAL ECONOMICS **Fee: \$85 205**

D. Fairfull, B.Com., A.A.S.A., Assistant Lecturer in Accounting
University of Hong Kong

*15 meetings, Fridays 6.15–7.45 p.m., beginning 13 February, 1970,
University Main Building*

The discrepancy between theory and practice is often emphasized. The aim of this course is to show how economic analysis can be used in formulating business policies. Topics to be studied will include profit, investment policy, cost control, competition, demand analysis, pricing policy and market strategy. Suitable for practising managers and business executives interested in the relevance of economic concepts and analysis to business problems and decisions.

206 STATISTICAL METHODS IN ECONOMICS & BUSINESS **Fee: \$65 206**

S.C. Fan, Ph.D., F.I.S., Senior Lecturer in Economics,
University of Hong Kong

*12 meetings, Fridays 6.00–7.30 p.m., beginning 13 February, 1970,
University Main Building*

Topics to be covered will be those with useful applications in business and economics. These include statistical estimation, tests of hypotheses, t, F and Chi-square distributions, regression and correlation, analysis of variance, basic sampling techniques and non-parametric methods. The first two lectures will be devoted to explaining elementary concepts in descriptive statistics. Previous knowledge in statistics will be an advantage, but not a prerequisite.

207 MANAGEMENT INFORMATION **Fee: \$45 207**

David K.P. Li, M.A., A.C.A.

*12 meetings, Mondays 5.45–6.45 p.m., beginning 16 February, 1970,
Extra Mural Town Centre*

The use and presentation of management information and the use of related techniques in Management planning, decision-making and control will be discussed. The course will cover such topics as interpretation of financial statements; corporate planning; management ratios, sale forecasting; computer based management information systems; research and development, and methods of improving efficiency of administrative departments. The course will be helpful to those executives who are responsible for accounting data or those who have to make decisions from data supplied.

Wong Man-tun, M.A.

14 meetings, Thursdays 8.00–9.00 p.m., beginning 12 February, 1970,
Lecture Room South, 8th Floor, City Hall

香港工業發展研究

本課程共十四講，主要探討與香港工業發展有關之各項問題，使工業界人士或其他有興趣人士能了解香港工業發展之過去，現在與將來。講題包括：香港經濟概觀；工業在香港經濟發展中之作用；香港工業發展之沿革及其前景；進一步發展香港工業之若干管理問題，諸如行業之選擇，規模之確定，廠址之選擇，設計中之平衡以及人事行政與成本管理等。

主 講 人：王文敦碩士

講授語言：粵語

地 點：香港大會堂九樓南演講廳

時 間：一九七〇年二月十二日起每星期四下午八時至九時

學 費：五十五元

209 TIME AND MOTION STUDY

Fee: \$60 209

Wong Man-tun, M.A.

16 meetings, Tuesdays 8.00–9.00 p.m., beginning 17 February, 1970,
Lecture Room South, 8th Floor, City Hall

工作研究（動作與時間研究）

本課程共十六講，主要探討如何在工業生產方面進行動作研究 Motion Study 與時間研究 Time Study 藉以消除工作中之多餘動作和費力動作，改善操作方法；消除無效時間，縮短生產週期；減少物力虛耗，降低生產成本；製訂時間定額，建立獎勵制度；不斷提高生產力，促進生產發展。

「工作研究」不僅對工業生產計劃管理，成本控制及獎勵制度之實施有重大意義，而且對任何其他方面工作之改進，提高工作效率，亦可獲得顯著成果。

本課程適合各行業工廠各級主管，技術人員，工作研究人員，以及其他興趣人士選讀。

主 講 人：王文敦碩士

講授語言：粵語

地點 點：香港大會堂九樓南演講廳

時 間：一九七〇年二月十七日起每星期二下午八時至九時

學 費：六十元

Francis C.Y. Chan, M.B.A.

*12 meetings, Thursdays, 5.45–6.45 p.m., beginning 19 February, 1970
Extra Mural Town Centre*

投 資 學

本課程共十二講，對有關投資的研究與處理之問題，有詳盡之討論。內容包括投資的目的，證券，互惠投資基金，參考資料之取得，購售手續，證券市場，有價證券之分析，時效問題，經紀人關係等。

主 講 人：陳暢餘碩士（工商管理學）

講授語言：粵語

地 點：香港大學校外課程部市區中心

時 間：一九七〇年二月十九日起每星期四下午五時四十五分
至六時四十五分

學 費：四十五元

211 PRACTICAL BANKING II

Fee: \$40 211

T.Y. Chan, B.A.

*12 meetings, Tuesdays 7.00–8.00 p.m., beginning 17 February, 1970,
Extra Mural Town Centre*

銀 行 實 務 (二)

本課程共十二講，繼續講述銀行實務，特別注意進出口押匯及跟單商業信用証。關於香港新銀行條例，中央銀行及其他重要問題，亦加以研討。

主 講 人：陳天元先生

講授語言：粵語（輔以英語）

地 點：香港大學校外課程部市區中心

時 間：一九七〇年二月十七日起每星期二下午七時至八時

學 費：四十元

75 TAXATION IN HONG KONG

Fee: \$60 75

J.K.S. Thong, F.C.I.S., F.A.C.C.A.

*15 meetings, Mondays 7.00–8.00 p.m., beginning 16 February, 1970,
Extra Mural Town Centre*

A comprehensive explanation will be given of the principles which govern individual and corporate liabilities and claims.

Particular attention will be paid to the powers and duties of the Board of Inland Revenue and the Board of Review.

B. Wythe, Member of the Public Relations Institute of Australia,
Eric White Associates

*10 meetings, Tuesdays 5.45–6.45 p.m., beginning 17 February, 1970,
Extra Mural Town Centre*

The necessity for good public relations is becoming increasingly evident in Hong Kong and is vital to the well-being of the community. Its role as an aid to modern marketing, as a means of conveying ideas and policies, and in assisting companies and institutions in developing sound reputations and relationships will be discussed. There will be some examination of the techniques of public relations and the qualifications that help to make a successful public relations officer or consultant. No previous knowledge of the subject is assumed.

Education

Staff Tutor in Charge: Nana Tsao, B.A., Dip.Ed.(H.K.) Telephone No. H-468161 Ext. 306

213 SCHOOL GUIDANCE & COUNSELLING: PSYCHOLOGICAL PRINCIPLES & PRACTICAL TECHNIQUES INVOLVED Fee: \$40 213

N.K. Henderson, Ph.D.(Lond.), B.A., M.Ed.(Melb.), A.B.Ps.S., F.C.P.,
Professor of Education, University of Hong Kong

*12 meetings, Thursdays 6.15–7.15 p.m., beginning 19 February, 1970,
University Main Building*

A course of twelve lectures applying the principles of modern psychology to the problems of school guidance and counselling. Film-strips will be shown, some stencilled notes and printed materials will be issued, and there will be plenty of opportunities for discussion and questions. The course is ideally suited to meet the needs of teachers with some experience in the classroom who wish to learn more of the psychological principles and practical techniques involved in modern educational guidance and school counselling.

*Staff Tutor in Charge: Jon A. Prescott, B.Arch., M.C.D.(Liv.), A.R.I.B.A., A.M.T.P.I.
Telephone No. H-226613*

214 THE TEACHING OF ART IN THE PRIMARY SCHOOL Fee: \$140 214

Martha Lesser, B.S.(N.Y.U.)

*24 meetings, Mondays 6.00–8.00 p.m., beginning 16 February, 1970,
Extra Mural Town Centre*

A course specially designed to give the Primary School teacher insight into what an art lesson is and how and why art can and should be included in the school curricula.

Much of the work will be devoted to exploration of simple, inexpensive and readily available materials and their uses in the classroom.

Instruction will be by way of seminars, studio sessions and constructive critiques designed to help evaluation of work achieved in the classroom. If possible the practical effects of methods outlined will be tried by teachers on their own pupils to enable judgements to be made of the effectiveness of the methods advocated.

The studio will be available for private use until 10.00 p.m., though formal instruction will be limited to the initial two hours of the evening.

Enrolment will be limited to 25 persons.

215 THE TEACHING OF ART IN THE SECONDARY
SCHOOL

Fee: \$140 215

Martha Lesser, B.S.(N.Y.U.)

*24 meetings, Fridays 6.00–8.00 p.m., beginning 20 February, 1970,
Extra Mural Town Centre*

A similar course to that designed for Primary School teachers but at the different level involved.

Similar arrangements will be made to those described under Course No.214. The studio will be available for private use until 10.00 p.m., though formal instruction will be limited to the initial two hours of the evening.

Enrolment is limited to 25 persons.

English Studies

Staff Tutor in Charge: D.J.H. Macintosh, M.A.(Cantab) Telephone No. H-468161 Ext. 304

- 221 MODERN POETRY** **Fee: \$35 221**
R. Kirkpatrick, B.A.(Oxon.),
Assistant Lecturer in English, University of Hong Kong
8 meetings, Wednesdays 6.15–7.15 p.m., beginning 8 April, 1970, Committee Room North, City Hall, Hong Kong
What direction is modern poetry moving in? How much influence have earlier poets like W.B. Yeats and T.S. Eliot had on the younger poets of the last few years? These are some of the topics that will be considered in this course which sets out to describe the predominant moods and styles of modern poetry. Cyclostyled copies of the poems to be considered will be available at the lectures.
- 216 READING AND DISCUSSION** **Fee: \$35 216**
J. Canning, B.A.(Lond.)
8 meetings, Fridays 6.15–7.15 p.m., beginning 13 February, 1970, University Main Building
A further course, principally intended for those who are following the "Use of English II" Course and for others who have a fairly fluent command of English. Various types of 'non-literary' English, including newspaper reports, editorials and controversial articles will be examined critically and discussed in class.
Textbook: W.E.K. Anderson, "The Written Word", Oxford University Press.
- 217 SPOKEN ENGLISH** **Fee: \$40 217**
D.J.H. Macintosh, M.A.(Cantab.)
9 meetings, Mondays 6.15–7.45 p.m., beginning 20 April, 1970, Language Centre, University of Hong Kong
This course is primarily intended for those who have completed the "Use of English I" Course and wish to improve their spoken English. Modern language laboratory teaching methods will be used to give practice in English pronunciation and intonation, English sentence patterns and rapid thinking and speaking in English.
Enrolment will be limited to 15 persons.

218 THE MODERN NOVEL **Fee: \$35 218**

M. Visick, M.A., B.Litt.(Oxon.)

Senior Lecturer in English, University of Hong Kong

8 meetings, Wednesdays 5.45–6.45 p.m., beginning 11 February, 1970, Extra Mural Town Centre

This course, which it is hoped will be more a dialogue between the group members than a lecture-course, is intended for those who already have a fairly fluent command of English. Four recent novels, "Anglo-Saxon Attitudes" by Angus Wilson, "Justine" by Lawrence Durrell, "A Burnt-Out Case" by Graham Greene and "The Fixer" by Bernard Malamud, will be read for critical discussion in the group.

219 MODERN DRAMA **Fee: \$35 219**

A.J. Varney, B.A., B.Litt.(Oxon.)

Assistant Lecturer in English, University of Hong Kong

8 meetings, Fridays 5.45–6.45 p.m., beginning 13 February, 1970, Committee Room North, City Hall, Hong Kong

In this course the Tutor will talk about and discuss with the group a number of plays written in the last few decades by some of the more important and influential English, European and American dramatists.

The following plays will be discussed:

Bertolt Brecht:	The Good Woman of Setzuan
Arthur Miller:	A View from the Bridge
John Osborne:	The Entertainer
Samuel Becket:	Happy Days
Robert Bolt:	A Man for All Seasons
John Whiting:	The Devils

220 MAJOR EUROPEAN DRAMA **Fee: \$35 220**

W.I. McLachlan, M.A.(Oxon.), Senior Lecturer in European Language & Literature, University of Hong Kong

8 meetings, Fridays 5.45–6.45 p.m., beginning 3 April, 1970, Lecture Room North, City Hall, Hong Kong

The recent award of the Nobel Prize for Literature to the dramatist, Samuel Beckett, has stimulated a new interest in European Drama. Rather than deliver a number of formal lectures, the Tutor in this course will lead a series of discussions on some of the European plays of the modern period that have always impressed their audiences.

The plays to be discussed are:

Henrik Ibsen:	Ghosts
August Strindberg	The Father
Luigi Pirandello	Henry IV
Bertolt Brecht	Caucasian Chalk Circle
Samuel Beckett	Waiting for Godot

PRIOR ENROLMENT IS ESSENTIAL

Failure to enrol prior to the opening of a particular course, may mean the cancellation of that course. Prior enrolment is the only way the Department of Extra-Mural Studies has of judging the response to its courses. Your co-operation is therefore invited in sending your application forms to the Department as soon as possible.

Geology and Geography

Staff Tutor in Charge: Jon A. Prescott, B.Arch, M.C.D. (Liv.), A.R.I.B.A., A.M.T.P.I.
Telephone No. H-226613

- 111 GEOGRAPHY IN THE FIELD (PHYSICAL) Fee: \$60 111**
Tam Sai Wing, B.A.(H.K.)
6 meetings & 6 field trips, Tuesdays 6.15–7.15 p.m., beginning 17 February, 1970, University Main Building, Field trips will take place on Saturdays/Sundays
The operation of physical processes on geological structure giving rise to special topographical features will be discussed in lectures and studied in detail during field trips. Methods of field investigation will be considered. There will be six lectures and six field trips. Places to be visited include: Ma Sze Chau/Lai Chi Chong, Deep Water Bay Road, Tai Lam Chung/Devil's Peak Area, Lam Tsuen/Pak Tam (Sai Kung Peninsula), Rocky Harbour/Lau Fau Shan, Ma On Shan/Needle Hill Wolframite Mine.
The course fee does not include expenses incurred on the excursions. Enrolment is strictly limited to 30 persons. Participants should be physically fit and capable of climbing and hiking.
- 112 GEOGRAPHY IN THE FIELD (HUMAN) Fee: \$60 112**
D.W. Drakakis-Smith, M.A., Dip.Ed.(Wales)
Department of Geography & Geology, University of Hong Kong
6 meetings & 6 field trips, Tuesdays 7.30–8.30 p.m., beginning 20 January, 1970, University Main Building, Field trips will take place on Saturdays/Sundays
The emphasis in these lectures will be on the geography of the urban community which constitutes some 90% of Hong Kong's population. Themes which will be covered will include the Central Area, Hawking, a New Town, a Recreational Settlement and New Territory Towns.
Potential students are warned that the field trips will involve a considerable amount of walking in the urban areas.
Enrolment will be limited to 20 persons.
- 110 QUANTITATIVE TECHNIQUES IN HUMAN GEOGRAPHY Fee: \$60 110**
Stewart F. Richards, B.Sc.(Econ.) (Lond.)
10 meetings, Wednesdays 6.15–7.15 p.m., beginning 11 March, 1970, University Main Building
The lecturer will discuss basic statistical techniques with geographical applications covering, measures of distribution, sampling, time series analysis, indices regression and correlation and significance testing and analysis of variance. Emphasis will be given to the usefulness of these techniques in geography. Time will also be given to recent developments in locational analysis, the use of models and computer applications.
Enrolment will be limited to 20 persons.

History

Staff Tutor in Charge: Nana Tsao, B.A., Dip.Ed.(H.K.) Telephone No. H-468161 Ext. 306

116 THE INFLUENCE OF SEA POWER ON MODERN EAST ASIAN HISTORY Fee: \$40

N.R. Bennett, Ph.D.(Lond.), Lecturer in History, University of Hong Kong
12 meetings, Tuesdays 6.15–7.15 p.m., beginning 17 February, 1970, University Main Building

What is sea power? What part does it play in the history and international relationship of China and Japan? This course attempts to explore and interpret the influence of sea power on Modern East Asian history, Topics, with a series of case studies, will include:

Strategy and Asian Geography

Sea Power and the opening of China and Japan

Sea Power and the Informal Empire: the Gunboat

Sea Power and Modernization: Japan's Quest and China's Failure

Sea Power and technological change: the Sino-Japanese War
1894–1895

Sea Power and diplomacy: Naval factors in the Anglo-Japanese
Alliance

The Russo-Japanese War

Sea Power and power politics: the Japanese-American arms race
1907–1922

Disarmament and diplomacy: the Washington Agreements

The New Era in the Far East: Sea Power and Asian security
1918–1941

The Second World War

Languages

Oriental

Staff Tutor in Charge: Nana Tsao, B.A., Dip. Ed. (H.K.) Telephone No. 468161 Ext. 306

The Oriental Languages Programme is taught in English unless otherwise stated. A good standard of English is essential for admission.

Course fees for courses 118, 121, 123, 125, 129, 131 include \$20 for 12 hours of laboratory work at Caritas House, Caine Road, of which at least 3 hours will be conducted by the Tutor during course time.

18 MANDARIN I **Fee: \$200** **118**

Shih Wan-Chu, B.A., Instructor in Mandarin, University of Hong Kong
40 meetings, Mondays & Thursdays 7.30–8.30 p.m., beginning 2 April, 1970, University Main Building

The main emphasis of this course will be on spoken Mandarin and ample opportunity will be given for practising pronunciation and short sentence construction orally.

Textbook: "Beginning Chinese" by John De Francis, Yale University Press

23 MANDARIN II **Fee: \$220** **123**

Shih Wan-Chu, B.A., Instructor in Mandarin, University of Hong Kong
40 meetings, Mondays & Thursdays 6.15–7.15 p.m., beginning 2 April, 1970, University Main Building

Students who have completed Mandarin I or those who can prove that they have done a reasonable amount of Mandarin in the past are welcome to join this course. Some characters and idiomatic expressions will be introduced and students will be taught to read simple passages.

Textbook: "Beginning Chinese" by John De Francis, Yale University Press

21 CANTONESE I **Fee: \$200** **121**

Paul Fong, B.A., Dip.Ed.(H.K.)

40 meetings, Mondays & Thursdays 7.30–8.30 p.m., beginning 19 March, 1970, University Main Building

This course will give students foundation work in Cantonese and aims at enabling them to understand and speak simple conversational Cantonese. Specially prepared and graded texts will be supplied.

125 CANTONESE II

Fee: \$220 125

Paul Fong, B.A., Dip.Ed.(H.K.)

40 meetings, Mondays & Thursdays 6.15–7.15 p.m., beginning 19 March, 1970, University Main Building

This course is intended for students who have completed Cantonese I or who can prove that they have had equivalent training in Cantonese. With the aim of developing thoroughly the student's conversational ability, the course will concentrate on the spoken language, expressions and idioms.

Specially prepared and graded texts will be supplied.

223 MANDARIN (Kuo Yu)

Fee: \$180 223

Pai Hsuan Chih, B.A.(Lingnan)

*40 meetings, Tuesdays & Fridays 6.15–7.15 p.m., beginning 24 February, 1970, University Main Building***國 語**

本課程共四十講，每週二講，每講一小時。內容有國語注音符號（包括注音字母及大陸現行標準拼音法），國、粵語發音，語法與詞句之差異，國語會話及新聞選讀等。

本課程限收廿五人，如報名人數衆多或國語程度高低不一，主理導師將審核分班或決定取錄（報名截止日期：一九七〇年二月十七日）

主 講 人：白選之先生

講授語言：粵語

地 點：香港大學校本部

時 間：一九七〇年二月廿四日起每星期二及星期五下午六時十五分至七時十五分。

學 費：一百八十元

129 CANTONESE I

Fee: \$200 129

C.S. Hung, B.A.(Chinan),

Instructor in Cantonese, University of Hong Kong

40 meetings, Mondays & Thursdays 2.00–3.00 p.m., beginning 23 March, 1970, Extra Mural Town Centre

This course will give students foundation work in Cantonese and aims at enabling them to understand and speak simple conversational Cantonese.

Specially prepared and graded texts will be supplied.

131 CANTONESE II

Fee: \$220 131

Francis Sham, B.A.(Sun Yat-sen),
Instructor in Cantonese, University of Hong Kong

40 meetings, Tuesdays & Fridays 2.00–3.00 p.m., beginning 24 March, 1970, Extra Mural Town Centre

This course is intended for students who have completed Cantonese I or who can prove that they have had equivalent training in Cantonese. With the aim of developing thoroughly the student's conversational ability, the course will concentrate on the spoken language, expressions and idioms.

Specially prepared and graded texts will be supplied.

European

Staff Tutor in Charge D J H Macintosh, M A. (Cantab) *Telephone No.* 468161 *Ext* 304

222 ADVANCED SPANISH

Fee: \$120 222

J.F. Domene, Ph.D.(Rome)

12 meetings, Tuesdays and Fridays 5.45–6.45 p.m., beginning 17 February, 1970, Extra Mural Town Centre

This course is intended for those who have completed the Extra Mural Course "Spanish III" and for others who have also achieved a fair fluency in Spanish.

Law

Staff Tutor in Charge: Priscilla Tso, B.A., Dip.Ed.(H.K.), Dip.Ad.Ed.(Manch.)
Telephone No. H-468161 *Ext.* 303

193 LAW OF PARTNERSHIP

Fee: \$40 193

David Ling, Solicitor

5 meetings, Wednesdays 7.00–8.30 p.m., beginning 8 April, 1970, Extra Mural Town Centre

The course will deal with the definition and formation of partnerships, relations between parties, relations to third parties, liability of parties and dissolution.

Mathematics

Staff in Charge: Priscilla Tso, B.A. Dip. Ed. (H.K.), Dip. Ad Ed (Manch.)
Telephone No. H-468161 *Ext.* 303

189 INTRODUCTION TO MODERN ALGEBRA Fee: \$60

Lee Kwok Pun, B.A.(H.K.) and Ho Siu Wing, B.Sc.(Special) (H.K.)
*12 meetings, Tuesdays 6.15–7.45 p.m., beginning 17 February, 1970,
University Main Building*

A course for A-level teachers and interested laymen. The following topics will be covered: algebraic structures, including groups, rings, fields, their elementary properties; substructures; homomorphisms and isomorphisms. Emphasis will be laid on the ability to recognize these structures rather than on their deeper properties.

Vector spaces—definition, elementary properties, linear dependence and independence, basis and co-ordinates. Linear transformations and matrix of a linear transformation. Matrices—definition, addition and multiplication, inverse; determinant of a matrices. System of linear equations. Attention will be given only to two and three dimensional vector spaces and $m \times n$ matrices where $1 \leq m, n \leq 3$.

A knowledge of elementary set theory is an advantage but not a necessity. Advanced Level Mathematics teachers who wish to have their fees refunded by the Director of Education are required to complete an application form (obtainable from the Department of Extra-Mural Studies, University of Hong Kong) which must be returned *directly* to the Director of Education before the commencement of the course. This applies to *all* teachers whether in Government or private schools.

190 MODERN MATHEMATICS FOR PARENTS II Fee: \$55

Tsui See Ming, B.A., Dip.Ed.(H.K.)
*15 meetings, Fridays 5.30–6.30 p.m., beginning 20 February, 1970,
Extra Mural Town Centre*

This is the second part of a series of courses intended to introduce the basic principles of modern mathematics to parents and interested laymen. Illustrations will be taken from the syllabus of lower forms in secondary schools.

159 MODERN MATHEMATICS IN PRIMARY SCHOOLS Fee: \$45 159

Timothy E.E. Bleach, B.A.(Southampton)

12 meetings, Wednesdays 5.45–6.45 p.m., beginning 18 February, 1970, Extra Mural Town Centre

The course aims to introduce parents and interested laymen to some of the basic principles of modern mathematics and to examine recent changes in the approach to the teaching of mathematics in primary schools. It will deal with topics selected from the syllabus of primary schools. Students will be asked to participate in practical work.

Enrolment will be limited to 25 persons.

188 INTRODUCTION TO CALCULUS II Fee: \$55 188

Stephen T.L. Choy, M.Sc., Ph.D.(Aberdeen) and
Lee Kwok Pun, B.A.(H.K.)

10 meetings, Fridays 7.00–8.30 p.m., beginning 20 February, 1970, University Main Building

The following topics will be covered: Polar Co-ordinates, Curve Tracing, Methods of Integration, the Definite Integral, Infinite Sequences and Series, Improper Integrals, Approximate Integration, Partial Derivatives, Double Integrals.

Applicants are expected to have a basic knowledge of limits, differentiation and integration.

Philosophy Psychology and Sociology

Enquiries: J.W. England, B.A.(Nottin.), Deputy Director, Telephone No. H-468161 Ext. 301

162 AN OUTLINE OF MODERN PHILOSOPHY **Fee: \$70 162**

T.C. Goodrich, B.A.(Birmingham),
Lecturer in Philosophy, University of Hong Kong

*20 meetings, Wednesdays 6.15–7.15 p.m., beginning 11 February, 1970,
University Main Building*

Intended mainly for school teachers who wish to assess the possibilities of ("Western") Philosophy as a school subject. It will not be an exposition of the "latest trends" in Philosophy, but, as far as possible, an outline of basic problems with direction as to where further information on topics of interest may be obtained. There will be opportunity throughout for discussion of the possible relations between the various aspects of Philosophy and other school subjects. The topics introduced will be those covered by the new Philosophy A Level Syllabus.

225 INTRODUCTION TO THE STUDY OF RELIGION **Fee: \$35 225**

Paul Gibson, B.A., L.Th.

*10 meetings, Wednesdays 6.15–7.15 p.m., beginning 18 February, 1970,
University Main Building*

A survey of the study of religion, especially primitive religions, from the enlightenment to the present day. The purpose of the course is to show the development of anthropological, sociological, psychological, historical and phenomenological approaches to human religious behaviour and to explore and discuss the extent to which residual religious tendencies remain in modern society and re-appear under the guise of supposedly secular institutions.

226 PHILOSOPHY, EAST AND WEST

Fee: \$40 226

Ian Watson, M.A.

12 meetings, Wednesdays 6.15–7.15 p.m., beginning 18 February, 1970, University Main Building

A comparative approach to contemporary Western Existentialism and traditional Eastern thought. Western Existentialism will, in the main, be dealt with through the work of Martin Buber, one of its most influential exponents, whilst Eastern thought will be approached through the Upanisads, writings which contain the central philosophy of Hinduism and Buddhism.

The course will concern itself especially with the question—"What is a person?"—as answered by these respective traditions.

195 HUMAN RELATIONS

Fee: \$45 195

Beryl Wright, B.Ec., A.B.Ps.S.,
Appointments Officer, University of Hong Kong*10 meetings, Wednesdays 5.45–7.00 p.m., beginning 18 February, 1970, University Appointments Service Office*

This will be a discussion group on the subject of Human Relations. Spontaneous discussion is the basis of this type of study, and the leader will serve as a facilitator of communication. Similar types of course in other countries have been described as "T groups", "training groups" or "sensitivity training".

Preference will be given to applicants whose previous experience and present type of work seem most likely to equip them for active participation. These would include especially people engaged in management, industrial relations and liaison work.

Enrolment will be limited to 25 persons.

196 CONTEMPORARY SOCIAL PROBLEMS

Fee: \$60 196

D. Han M.A.

12 meetings, Thursdays 7.15–8.45 p.m., beginning 12 February, 1970, Committee Room South, 7th Floor, City Hall

A sociologist looks at social problems and considers their significance in Hong Kong and other societies. Among the problems to be discussed are suicide, drug addiction, population, divorce, prostitution, mental illness, juvenile delinquency, corruption and housing.

Recommended reading: "Contemporary Social Problems" edited by R.K. Merton
"A Sociological Approach to Social Problems" by Noel Timms, Routledge Paperback

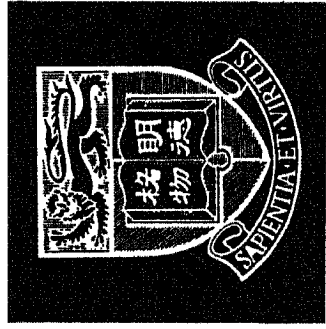

Extra Mural Studies 校外課程 Application for Enrolment 報名申請書

每一種課程請用別紙填寫

PLEASE USE A SEPARATE FORM FOR EACH COURSE

A

課程號碼 COURSE NO. FEE ENCLOSED \$
附學費
課程名稱 COURSE NAME CASH/CHEQUE NO.

姓名 NAME in full (Mr / Mrs / Miss) English
英文 in block letters – surname first
Chinese
中文

前已讀其他校外
課程名稱

What Extra Mural Courses have you previously attended?

姓名 NAME IN FULL (Mr / Mrs / Miss) English
英文 in block letters – surname first
Chinese
中文

通訊處 ADDRESS for correspondence

辦事處地址 OFFICE ADDRESS

電話 TELEPHONE NOS Home 住宅 Office 辦事處

國籍 NATIONALITY Age 年齡 (please tick age group)
18-19
20-29
30-39
40-49
50-59
over 60

職業 OCCUPATION

學歷 SCHOOL and highest class reached

大專學歷 HIGHER and/or FURTHER EDUCATION

B

DATE 日期

SIGNATURE 簽字

DATE REG. NO. COURSE NO. AMOUNT

DATE REG. NO. COURSE NO. AMOUNT

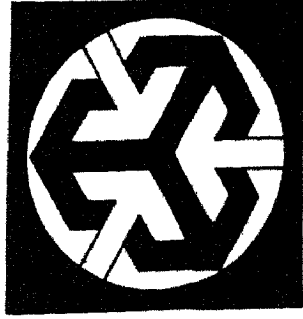

If you are applying by post and require an acknowledgment of your application, please complete this part
Note This application acknowledgment is not complete without validation by official printing machine entry of the details at X above at the University or Town Centre office of the Department of Extra-Mural Studies University of Hong Kong

NAME
FULL POSTAL
ADDRESS

Fees are not refundable once the course has commenced. Please see overleaf.

預早報名之重要

有冇修讀本部課程者應儘早報名，如不預先報名可引致各該課程延期開課或取消。預先報名乃是使本部得知各界對種種課程反應之唯一途徑，故報名表格應從速寄回本部。

香港大學校外課程部

UNIVERSITY OF HONG KONG DEPARTMENT OF EXTRA-MURAL STUDIES

A 與 B 聯填寫後附學費
送交香港大學校外課程
主任，

繳費可用支票或現金，如
用支票請抬頭「香港大學
」并加橫線逕寄本部。

除非課程臨時取消或改期，請依照公佈日期上課；本部不另通知。如報名申請未被接受，學費將退還，但課程開始後，學費通常不能退還。

PRIOR ENROLMENT IS ESSENTIAL

Failure to enrol prior to the opening of a particular course, may mean the cancellation of that course. Prior enrolment is the only way the Department of Extra-Mural Studies has of judging the response to its courses. Your cooperation is therefore invited in sending your application forms to the Department as soon as possible.

THE WHOLE OF THIS FORM TOGETHER WITH THE APPROPRIATE FEE SHOULD BE SENT TO THE DIRECTOR OF EXTRA MURAL STUDIES
THE UNIVERSITY OF HONG KONG

PAYMENT MAY BE MADE IN CASH OR BY CHEQUE AT THE UNIVERSITY OR BY POST
CHEQUES SHOULD BE CROSSED AND MADE PAYABLE TO 'UNIVERSITY OF HONG KONG

THE ISSUE OF AN ENROLMENT APPLICATION ACKNOWLEDGMENT DOES NOT OF ITSELF CONSTITUTE ACCEPTANCE OF THE APPLICATION, BUT IF YOU DO NOT HEAR OTHERWISE BEFORE A COURSE STARTS, YOU MAY ASSUME YOU HAVE BEEN ACCEPTED IF FOR ANY REASON YOU ARE NOT ACCEPTED YOUR FEE WILL BE RETURNED, BUT OTHERWISE FEES ARE NOT NORMALLY REFUNDABLE

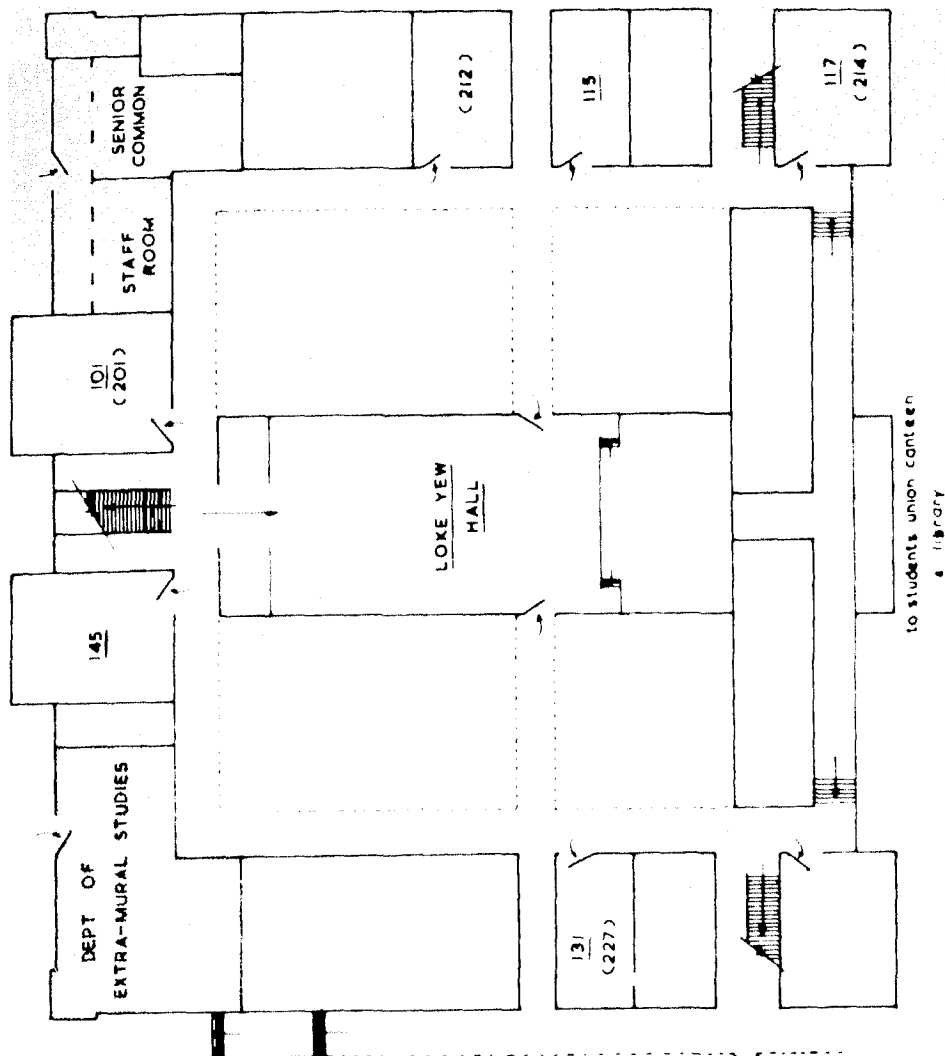

GROUND PLAN OF UNIVERSITY OF HONG KONG MAIN BUILDING
 Showing room locations used for Extra Mural Studies courses. Please see inside of front cover for University general layout.

Extra Mural Studies
University of Hong Kong



香港大學校外課程手冊
一九六九至一九七零

Spring Supplement 1970